

The Professional Painter & Decorator

VAN GOGH
DID IT. CÉZANNE
DID IT. WE DO IT. WE
SIGN EVERY SINGLE
MASTERPIECE WE
MAKE TOO.

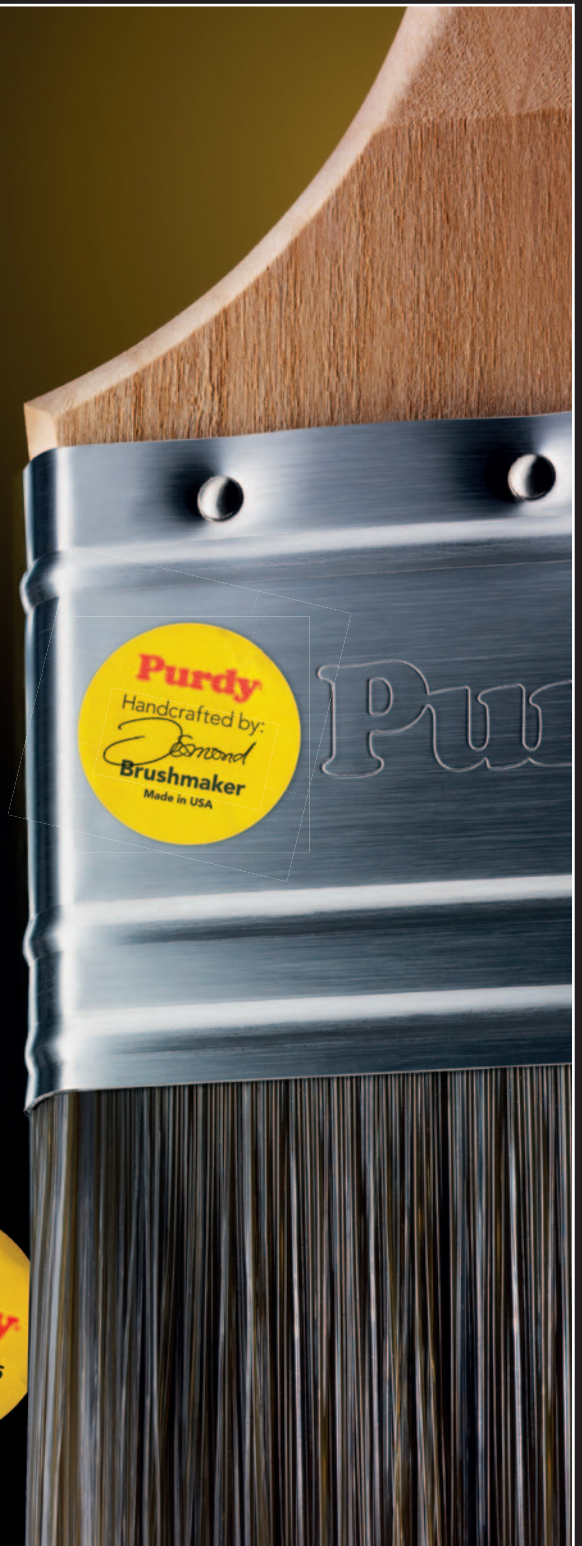

AUTUMN 2018

purdy.co.uk

**ULTRA
GRIPPY
BACKING!**



***300% MORE
SLIP RESISTANT THAN CANVAS!**

STAY PUT® CANVAS PLUS DROPCLOTH

WITH SURFACE GRIP + SPILL BLOCK®

- ✓ **SLIP RESISTANT + DURABLE**
- ✓ **SURFACE GRIP BACKING**
- ✓ **LEAK RESISTANT TO ALL PAINTS + STAINS**

 **TRIMACO**

Manufacturers of KleenEdge Low Tack Painting Tape
01746 218091 | www.trimaco.com

Ciret Ltd

UK distributor for Trimaco products
02392 457450 | www.ciret.co.uk

The Professional Painter & Decorator

INCORPORATING THE PAINTING & DECORATING JOURNAL

News	2
Malachite	10
Specialist finishes expert Cait Whitson explains how to achieve this stunning finish.	
Problem solving paint	12
Lindsay Hall, brand manager from Crown Trade, looks at some of the latest product innovations designed to withstand extensive cleaning.	
Just what can be in paint	16
People with asthma and allergies are advised to avoid volatile organic compounds. When painting the home, how can you reduce their exposure and what should you be looking out for in your paint? By Dr. Tim Yeomans.	
The voice of colour	20
With the right tools and knowledge on the latest shades and trends, you can provide a valuable service to customers, helping them achieve their colour goals. Here, Charlie Stafford, Johnstone's Marketing Manager, explains how Johnstone's Trade is helping professional painters and decorators advise on colour.	
The National Painting & Decorating Show 2018	28
Just to whet your appetite, here are just a few of the products and services you'll get to see at this, the biggest show dedicated to our trade.	
Workwear for women	32
With more and more women working in the trades, it seems logical that they should have their own workwear.	
Trompe L'oeil: Faux bricks	34
Lynda Bergman explains how she created faux bricks to match in with real ones in a recent project of hers.	
On test: Circular Saws	38
On test: Citroen Relay 35 L3H2 Enterprise HDi 160 6-speed	40
Marketplace	44



The National Painting & Decorating Show
Nov 27th - Nov 28th 2018

Editorial David Pescod
Advertising Richard Daynes

Published by
DPA Publishing Ltd
 Stoney Lane Barn
 Stoney Lane
 Bovingdon
 Herts HP3 0LY

Editorial: 01303 238002
Email: davidpescod@aol.com

Advertising & Subscriptions: 01442 832715

Production The Orange Design Group

Printed by Wyndeham, Roche
Subscription £18.00 p.a. (in the UK)

Subscribe to the

The Professional Painter & Decorator

only
£18 per year
 (including postage)



It's the only way of ensuring you receive your copy

Published 4 times per year - February, May, August & November

Make cheques payable to
DPA Publishing Ltd

Orders can only be accepted with payment

Send to:

DPA Publishing Ltd

Stoney Lane Barn, Stoney Lane,
 Bovingdon, Hertfordshire HP3 0LY

SUBSCRIPTION

Name: _____

Company: _____

Address: _____

Postcode: _____

Email: _____

AkzoNobel's Visualizer app passes 20 million

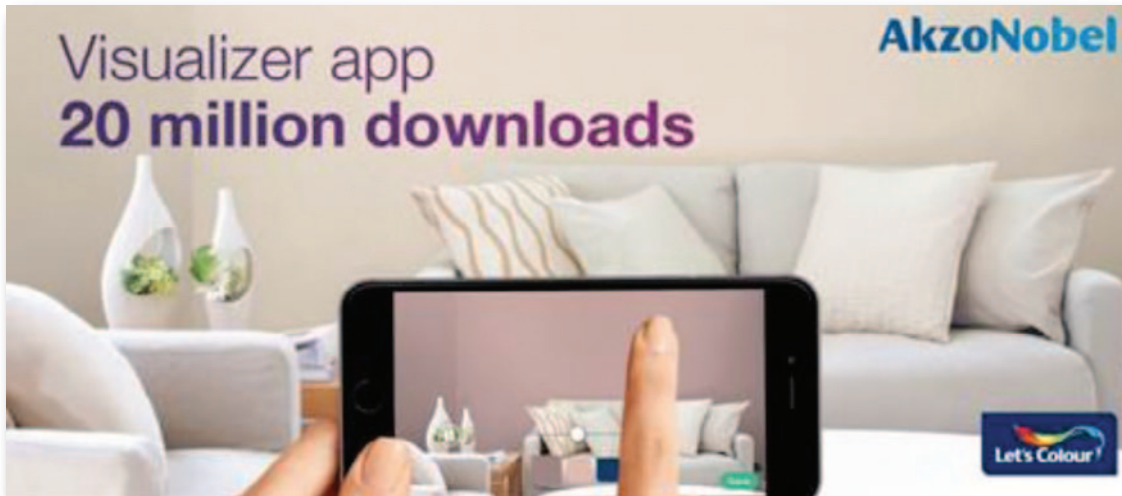

Giving people the simple pleasure of making confident color choices has propelled downloads of AkzoNobel's Visualizer decorating app past the 20 million mark.

The award-winning digital colour tool was first launched in 2014 and is now

available in more than 60 markets. It allows consumers to visualize walls in different shades in real time, before applying a single drop of paint. To celebrate 20 million downloads of its visualiser, Akzo Nobel is giving members of the public the opportunity

to virtually paint museums at London's Trafalgar Square and Amsterdam's Museumplein by using the Visualizer. "We're delighted that the Visualizer is proving so popular and has established itself as a leading digital tool for colour," said Corinne Avelines, AkzoNobel's Director of Digital and e-Commerce. "Finding the right colour can be a stressful experience, which is why 21% of those who start the paint journey drop out before purchase. The Visualizer is designed to take away the worry of choosing color and make decorating fun again."

WWD



selection of paints

Crown's new colour guides

Crown has streamlined its existing colour cards to create one comprehensive and convenient Product & Colour Guide. The new guide includes key information for Crown's complete coatings range, with each product grouped into one of seven clearly defined sections including primers and preparation, walls and ceilings and exterior paints. It includes Crown's full colour palette as well as BS and RAL colour options. There's even a handy section at the back to make notes and jot down your product requirements as well as lots of useful advice and guidance to help with your project, from preparation tips to guidance on choosing the most effective colour scheme for a room.

Crown Trade's popular Historic & Classic



Colours Collection guide has also been given a new look. The chip mounted colour card provides easy access to a total of 150 colours across nine palettes, each inspired by a different historical era and available in a choice of finishes from across Crown Trade's extensive product range. For ease of reference, the most popular shades have also been grouped together to create a quick and simple tool for staying up to date with the most enduring colour trends.

Teknos protects RNLI

Teknos coatings were used by Paling Joiners to protect the external joinery, including windows and door sets, of the RNLI boat stations in St Davids (2016), Swanage (2016), Scarborough (2016), Llandudno (2017) and Bridlington (2017).

Accoya® wood, a modified timber in which a process called acetylation enables it to resist rot and defy the elements, was selected as the material of choice for this project. With its outstanding durability and dimensional stability, it offers a 50-year above ground and 25-year in ground/freshwater guarantee. This provided peace of mind that it will stand the test of time and withstand the coastal elements, keeping the building strong for decades.

Paling Joiners chose Teknos coatings and Accoya® due to the guarantees and warranties of the products

DEEST



Brewers
DECORATOR CENTRES



Over 150 branches, for your nearest call 01323 411080 or visit www.brewers.co.uk

Over 150 branches, for your nearest call 01323 411080 or visit www.brewers.co.uk

How much do you earn?

The best and worst cities for painters and decorators to work in the United Kingdom have been highlighted in a new survey. Workwear specialists MI Supplies analysed the yearly pay for painters and decorators in every city in the UK. Their research shows which cities you can earn the most and least money from working in if you are in the painting and decorating trade.

They discovered that Bradford is the best city in the UK for painters and decorators to make a living. The average pay for those working in Bradford is £24,040. London comes in second place with an average £23,889 per annum wage.

Painters and decorators working in Cambridge and Newport, meanwhile, have the lowest yearly salaries. They both came at the bottom of the list with £19,434 the average wage for Cambridge painters and decorators, and £19,602 for those in Newport.

The average wages for painters and decorators have increased by 8% since 2013. There is also a £4,606 difference between the average pay for painters and decorators working in Bradford compared to the lowest earning UK city Cambridge.

The five best places to make a living in the United Kingdom as a painter and decorator are:

1. **Bradford** – £24,040
2. **London** – £23,889
3. **Gloucester** – £23,640
4. **Salisbury** – £21,320
5. **Aberdeen** – £21,190

Meanwhile, the five worst are:

1. **Cambridge** – £19,434
2. **Newport** – £19,602
3. **Leeds** – £19,608
4. **Leicester** – £19,636
5. **Derby** – £19,995

MI Supplies analysed the yearly salaries for painters and decorators with at least five years of experience across all 69 cities in the UK.



Crown's 100 per cent recycled plastic containers

Crown's plastic 2.5 litre and 5 litre containers have been manufactured by packaging solutions expert Emballator, using 100 per cent post-consumer waste (PCW) plastic for each container.

The manufacturing process involves separating polypropylene plastics such as shampoo bottles, yoghurt pots, plastic water bottles and even elements from household appliances from unusable plastic waste - saving thousands of tonnes of PCW plastic from otherwise ending up in landfill. Once sorted, the PCW plastic is turned into

individual pellets which are then dyed and moulded to create Crown's 2.5 litre and 5 litre paint containers, with the dark grey shade making them instantly recognisable to consumers.

The paint containers, which will soon be rolled out across the entire Crown Paints range including its larger 10 litre tubs and Crown Trade products, are also fully recyclable once empty and clean. With such sustainability credentials, the new paint cans are the ideal choice for today's environmentally conscious consumers.

Tragic fall leads to avoidable death

The need for proper planning and supervision of work at height activities has been tragically highlighted with the death of Justin Newitt, who fell five meters through an opening on the roof at Maidstone Studios Limited.

The incident happened after Mr Newitt accessed the roof using a mobile access tower that was intended for performing works below, not for climbing on to the roof. However, no formal planning had been recorded and there was no supervision on how the work was being carried out.

The conviction of Maidstone Studios Limited featured in a recent Health and Safety Executive (HSE) press release, which also illustrated a lack of planning with regards to

the condition the tower:

"The tower scaffold used to access the roof was damaged, had not been correctly erected and had been purchased second hand by Maidstone Studios Limited with no manufacturer's instructions.

No-one identified the errors with the towers, ladder sections being the wrong way around, damaged bracing or the inadequate guardrails."

The release also highlighted that Mr Newitt was not trained to erect the tower safely.

Maidstone Studios Limited has been ordered to pay over £36,000 in fines and costs for breaching the relevant sections of the Health and Safety at Work Act 1974.

Got Armstead in the van?



JOB DONE!

Find out more information at
armsteadtrade.co.uk

Coating for thermal performance

Dulux Trade has provided a coating specification for a four-bedroom Victorian property houses a member of Tonbridge School's teaching staff and family onsite. As an older building, there was a growing concern surrounding its thermal efficiency. Made from solid wall construction, the property suffered from damp as well as extensive heat loss through the walls, reducing the inside temperature significantly. Tonbridge School was keen to find a product that could help improve the thermal performance – without disturbing the existing solid wall structure.

In response to this brief, the Dulux Trade proposed a bespoke specification which included the newly launched Dulux Trade Plus range. The new Plus range is designed specifically to help improve the thermal efficiency of the UK's ageing housing stock.

Dulux Trade Plus Thermacoat+ is a 3-part coating system comprised of a basecoat with

insulating properties, a leveling fiberglass fleece and a Dulux Trade Plus Smooth & Protect+ finish. Applied to all of the interior externally facing walls of the property, the Thermacoat+ system is just 6mm thick once complete making it an ideal solution for this project, as maximising space was key to the refurbishment – all whilst reducing heat loss through walls, improving room warm up times and resident comfort.

With the Dulux Trade Plus Thermacoat+ new to the market, it was important that the painting subcontractor and appliers on the project had both the skills and the knowledge to successfully apply it. As such, they attended a training day at the purpose built Dulux Academy in Slough. This offered an opportunity for the appliers to gain insight on the details of Thermacoat+ and best practice to follow when applying it to ensure the best possible finish and performance.

Bond It offers golden opportunity

Until October Bond It will be promoting Gripbond PRO which will see anyone buying a box of Gripbond PRO in any colour - which includes white, black, grey and crystal clear - being offered the chance to win a free Samsung tablet. Bond It will be giving away one of these mobile devices in each of the five months of the promotion. Winners will be determined through special golden tickets which will be inserted into certain boxes. The winning boxes will also contain an exclusive tube of limited edition gold coloured Gripbond PRO complete with a gold nozzle.



Don't *just* decorate... **BEDEC-ORATE!**

Innovators in Water-based Technology

Bedec Products Ltd., Units 1 & 2 Poplars Farm, Aythorpe Roding, Dunmow, Essex. CM6 1RY
Tel: +44 (0) 1279 876 657 **Email:** info@bedec.co.uk **www:** www.bedec.co.uk

Woodcare
Experts Since
1912



Home
ColourCare®

Bring colour to your furniture and flooring



Decorative Floor Varnish

- Highly durable protection
- Contemporary metallic finish
- Suitable for old laminate floors



Decorative Furniture Varnish

- Highly Durable
- Multi-surface Varnish
- Easy Application



Decorative Furniture Wax

- Metallic and Pearlescent Finish
- Natural Wax Formula
- Resistant to Stains and Water

Check in store to find out more about these
innovative woodcare products. www.liberon.co.uk

Stormdry EPC helps meet energy standards

Safeguard Europe has developed a system to improve the energy efficiency of solid-walled properties. The launch of Stormdry EPC comes as the new Minimum Energy Efficiency Standards (MEES) relating to rented properties have taken effect. The new standards, which originate in The Energy Act 2011, say that from April 1st this year any commercial or residential property that is being let for the first time, or where a lease is renewed, must achieve an Energy Performance Certificate (EPC) of Grade E or above.

Historically, properties with solid walls, rather than cavities, have been the most difficult and challenging to insulate. Typically for these properties, 54% of their heat goes through their walls, a figure which can rise for end-of-terrace homes or bungalows.

The system combines two Safeguard technologies to treat a wall both inside and



out: Stormdry masonry cream and a 'skinny' IWI panel. The result is a system which reduces the U-value of a damp, uninsulated masonry wall from 1.7 W/m²K down to 0.87 W/m²K.

For a typical mid-terrace property with uninsulated solid walls that has an EPC rating of F, the application of the Stormdry EPC alone would be sufficient to move it up to the E rating required under MEES. For a ground floor flat or a small semi-detached

house, the E rating could be achieved with very minor additional investment such as an insulating jacket for the boiler, energy efficient lighting and draft sealing.

Stormdry masonry cream can be applied with brush or roller to brick, mortar, sandstone or concrete. It provides a breathable membrane, coating the inside of the pores of the substrate so that water can evaporate out through it but cannot penetrate in. This means that, unlike some competitor products, it can be applied to wet walls because it will allow the water to evaporate out.

The IWI comes in 13mm-thick flexible panels which can be stuck straight onto existing walls. It is made from an aerogel, which has extremely low thermal conductivity due to its highly porous nature. Its super-slim profile means that a room's dimensions are barely diminished and that period features do not have to be sacrificed.

bromboroughpaints

Wallcovering & Paint Specialists. Est. 1948

Now open in Stoke!

- All major brands available
- Colour mixing service
- Extensive selection of wallcoverings
- Wide range of decorating tools & materials
- Competitive prices
- Friendly, expert advice

For more information call: 0151 334 1237
or visit www.bromboroughpaints.co.uk



...we've got the North West covered!

CROWN

DECORATING CENTRES

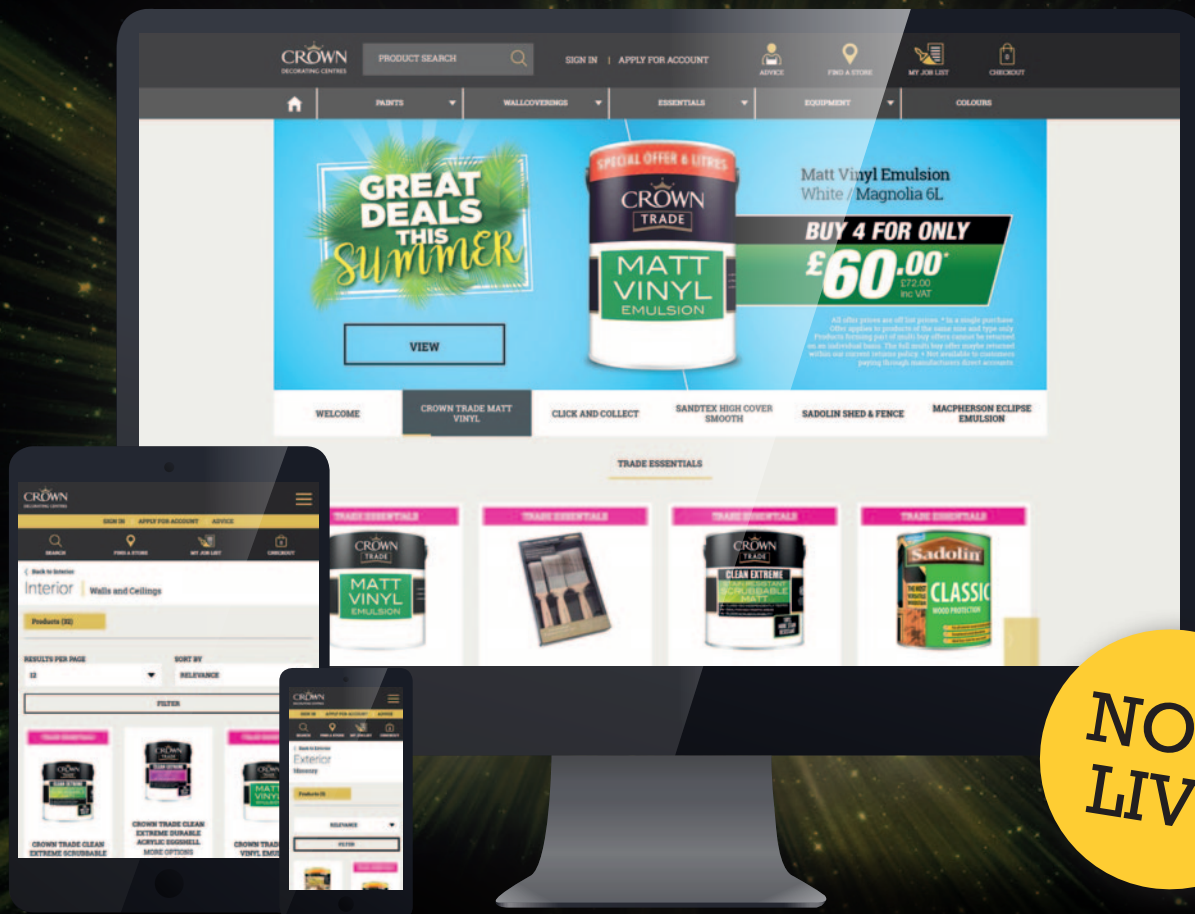

**NOW
LIVE**

NEW ONLINE STORE

www.crowndecoratingcentres.co.uk

BENEFITS TO OUR CUSTOMERS



**MANAGE YOUR
ACCOUNT ONLINE**



**SAME DAY
CLICK &
COLLECT***



**KEEP A RECORD
USING MY
JOB LISTS**



**NEXT DAY
DELIVERY***



**CHOOSE
COLOUR
ONLINE**



**MORE
CHOICE
ONLINE**



**EXPERT
ADVICE**

* Only applies to products that are in stock.

It's not just paint.
It's personal.®

Malachite

Cait is decorative painter working throughout UK and teaching from her studio in Perth, Scotland. You can see her work and connect with her on social media; Twitter and Instagram - @paintycait or Facebook - <https://www.facebook.com/carteblanchedecorativepainters/>

Malachite is Copper Carbonate, typically associated with copper deposits around limestones, the source of the carbonate. It forms most commonly in stalactites and botryoidal formations; botryoidal comes from the Greek and means resembling a bunch of grapes. You can see pictures of Botryoidal

Malachite carved vases in the Hermitage Museum, Malachite Room, these huge pieces are rare.

More often the mineral is cut and pieced together like a mosaic. When I first started in this industry

Malachite was a standard finish that you learned. Classed among the “Bravura” Finishes it went with Lapis Lazuli and Tortoiseshell. In the 90’s these fell out of fashion,

So Malachite went on my business back burner.

The past 2 years I’ve started to see it creep into interior design.

Malachite wallpaper, rugs and upholstery fabrics and this tells me it’s back!! It’s the easiest of all the Bravura finishes and a great finish to use as an inlay or border; it makes a stunning table-top and I did a lovely fireplace, years back, in fragmented malachite for Colefax and Fowler.



Materials used were – The eggshell basecoat for the first piece was Benjamin Moore’s Floradale Isle 581, similar to BS14 E 53, the second was Benjamin Moore Harbor Side Blue 740. The glaze was the same for both - Fusion Clear Glaze tinted with Phthalo Green and Lamp Black thinned about 10% with water. You could use Polyvine with tints Emerald, Prussian Blue and Black but I wanted to try this glaze out. I found it a nice glaze to use with a very good

open time. The main tool is bits of card. I’ve found that old shiny greetings cards are best, although I’m sure you could use anything to hand and get interesting results. You will need a laying on brush and some rag.

Stage 1 For the freeform Botryoidal Malachite done first I laid the glaze on and created some rough ideas of shapes with the brush to give me a compositional guideline and to thin and even out the glaze a bit. Because you are scraping through the glaze it

Stage 2



Stage 3



leaves ridges – too thick a ridge will take a long time to dry. Fold the card and tear straight edged pieces that are varied in size. Draw the torn edge of the card through the glaze creating interesting malachite style shapes. Wipe off the card after each pass. One bit of card will work brilliantly while the next won't and equally your brilliant bit will become soggy and stop working so you need to have lots of bits to work with. Some people cut teeth into the card, however I find this ends up looking a bit repetitive and it's time consuming.

Stage 2 The fragmented design in a more teal colour with lightly broken bronze grout is a modern twist. Draw up your design of fragments in water

colour pencil, this will dissolve as you paint. Mask up alternate shapes and carry out the same process. For this you might want to dilute the glaze further to encourage drying as it has to be carried out over 3-4 phases. I used a hairdryer to speed the drying and the Tesa Pink masking tape as this won't damage freshly painted sections.

Stage 3 Once your piece is complete varnish to protect with a semi-gloss or high gloss varnish.

I first learned this technique 32 years ago at The Pardon School of Specialist Decoration. Leonard Pardon sadly died earlier this year and I wrote this with his memory in mind.



Materials Used –

Fusion Mineral Paints Clear Glaze available from ColourMeKT - <https://colourmekt.myshopify.com/>
 Artists Acrylics – Black and Phthalo Green available from Jackson's Art Supplies
<https://www.jacksonsart.com>
 Alternatively - Polyvine Clear Scumble and Polyvine Tints Black, Emerald and Prussian Blue also available from Jackson's Art Supplies
<https://www.jacksonsart.com> or Gold Leaf Supplies
<https://www.goldleafsupplies.co.uk/>

Problem solving *paint*



Choosing advanced paint products that have been specifically developed to withstand intensive cleaning and retain that ‘just decorated’ look for longer can enhance your reputation.

Lindsay Hall, brand manager from Crown Trade, looks at some of the latest product innovations available and the benefits they can offer.

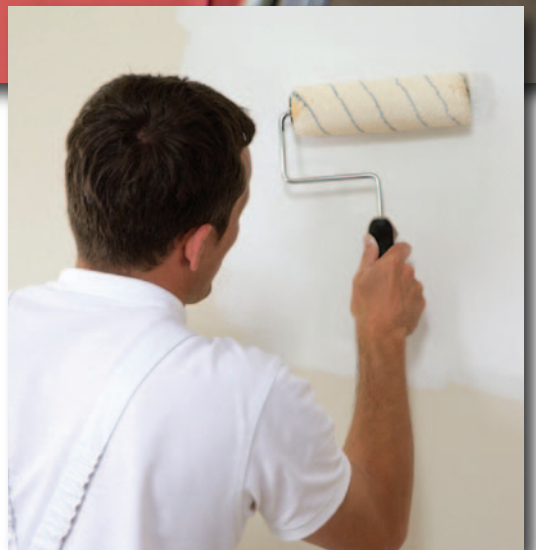

In today's hygiene conscious world, surfaces need to be ultra clean and walls and ceilings are no exception. Whether part of a standard clean up in a domestic property or a more intensive maintenance programme in a school or healthcare facility, a common problem of regular and rigorous cleaning is that it can wear away the paint finish and leave décor looking tired. To overcome this, manufacturers such as Crown Trade have invested heavily in the development of paints that can not only be wiped clean, but can be repeatedly scrubbed over

longer periods without any detriment to the appearance of the paint.

So how do they work? Cleanable paints such as Crown Trade's Clean Extreme range have been specially developed and tested to be able to withstand intensive cleaning by minimising the amount of paint film that is removed each time. Based upon the ISO 11998 testing method, which is the industry standard for determining the wet scrub resistance of dry paint film, Crown Trade's Clean Extreme Scrubbable Matt achieved a Class

1 rating and has a durability level of 10,000 scrubs, which translates to a 400 per cent increase in resistance to wet scrubbing when compared to conventional matt emulsions.

Although they have been specifically formulated to be repeatedly cleaned, the best products on the market are those that actively prevent stains appearing in the first place too. Choosing a product that is both scrubbable and stain resistant can offer the best of both worlds and may actually help extend time between



WERNERCO™

THE INDUSTRY'S MOST HIGHLY DECORATED LADDERS.

We know how important it is for you to have the right tools to do your job. Our ladders are designed with you in mind and come with additional features to help to make your job easier and productive.

Your safety is our priority.
That's why all our ladders are tested to the highest standard using latest state of the art technology.

**Available from all
leading Decorator
Centres throughout
the UK.**



YOUNGMAN®



cleaning. Paints that contain built-in protection that can't simply be washed away also provide additional peace of mind and are particularly suited for areas that need to be kept as hygienic as possible.

Even when surfaces look clean, they can be a breeding ground for bacteria. Historically, anti-bacterial paints have been prone to the problem of leaching, which is when the organic or chemical anti-bacterial agents migrate to the surface of the paint film over time where they can be wiped away. However manufacturers have developed products which offer protection that can't be washed off no matter how many times the surface is scrubbed clean. For example, Crown Trade's Clean Extreme Anti-Bacterial Scrubbable Matt utilises the natural protection of silver ion technology, which not only inhibits the growth of any bacteria that comes into contact with the surface but also prevents bacteria from multiplying.

Another common problem is mould and mildew which if painted over without treatment, will simply come back. For specific problems areas, it is worth considering a paint such as Crown Trade's Clean Extreme Mould Inhibiting Scrubbable Matt which is not only stain resistant but contains an active fungicide to prevent the growth of mould on the paint film.

The high performance formulation of cleanable paints has led them to be regarded as specialist paint solutions but in fact the wide range of benefits they can offer makes them ideally suited to a variety of different projects.

Paints that can be scrubbed and repeatedly cleaned are extremely effective when used in high traffic areas such as corridors or hallways in private



and rental homes or busy school and office environments. Extending the life of the paint finish is another key benefit and this can bring long term savings by reducing the number of future redecoration cycles.

Using anti-mould paints as a precautionary measure in rooms such as kitchens and bathrooms which are prone to condensation can also help avoid any long term and potential costly problems in the future. Similarly, using anti-mould paints in the residential rental sector, particularly in void properties that are likely to empty and unheated for some time, will help keep interior décor looking cleaner and fresher for longer.

Additionally, although anti-bacterial paints are often marketed for use in hospitals and other healthcare projects, they are becoming increasingly popular in other areas where improved hygiene is beneficial, such as food preparation facilities and children's play rooms.

As well as offering targeted solutions to specific problems such as stains, mould and bacteria, the flexibility offered by cleanable paints is helping to fuel their popularity. Many, such as Crown Trade's Clean Extreme water-based range, are available in both high performance matt and acrylic eggshell finishes and a wide range of colours to offer excellent design versatility. Add to this the fact they boast low odour and quick drying properties and it's easy to see why the new generation of cleanable, scrubbable and stain resistant paints are really making their mark and allowing professional decorators to make theirs.

For more information, please visit www.crowntrade.co.uk, email Info@crowntrade.co.uk or call 0330 024 0297.

VAN GOGH
DID IT. CÉZANNE
DID IT. WE DO IT. WE
SIGN EVERY SINGLE
MASTERPIECE WE
MAKE TOO.



Just what can be in paint

By Dr. Tim Yeomans

People with asthma and allergies are advised to avoid volatile organic compounds but this is not always possible. If you are painting at the home of someone in certain circumstances these can be unavoidable. When carrying out necessary tasks such as painting the home, how can you reduce their exposure and what should you be looking out for in your paint?

We all know that organic solvents are the main source of VOCs in paint and are the carrier in solvent based coatings. But what about water based paints?

What chemicals are in paint?

Water-based paints were created in response to demand for healthier and greener paint options and naturally have significantly lower solvent and VOC content but with the removal of solvent from paint, certain functional properties need to be replaced with substitute compounds.

Microorganisms can't grow in cans of solvent based paints, therefore water-based paints, require a preservative to suppress any significant microbial growth. In 2017, a well known paint company removed a preservative from a paint line that was on sale in an independent DIY chain. Unfortunately, as this was a water



based paint, this removal allowed bacteria to grow in the paint cans. When the paint was applied to walls, it resulted in a smell that was compared to cat urine and rotten animals! This smell was due to the production of ammonia and hydrogen sulphide by bacteria in the paint cans. However there are certain additives that can create problems for the vulnerable. These include:

Formaldehyde

Formaldehyde is added to paint to inhibit bacterial and fungal growth. However there are several health concerns with respect to the off-gassing of formaldehyde from freshly painted indoor surfaces. An increase in formaldehyde and VOC levels after painting correlates with asthma and bronchial hyper-responsiveness. A relation between nocturnal attacks of



FESTOOL

Copes with **high volumes** of dust.

Efficient, simple and reliable.

The new CT pre-separator with cyclone technology.

Large sanding areas and large quantities of dust place a great amount of strain on the main filter, which in turn affects the suction power. Mineral sanding dust from renovation sanders or long-reach sanders such as RENOFIX and PLANEX clogs the pores of the filter system and consequently reduces the suction power.

The CT pre-separator separates and collects approx. 80% of the accruing quantity of dust before it reaches the mobile dust extractor. This takes the strain off the main filter and guarantees consistently high suction power throughout the entire work process.

For more information, go to www.festool.com

Tools for the toughest demands

breathlessness and indoor concentrations of formaldehyde and VOCs in the home was also found. The United States Environmental Protection Agency (EPA) recognised that everyone is exposed to small amount of formaldehyde in the air, and exposure can cause irritation of the eyes, nose and throat and neurological effects.

Acetaldehyde

Acetaldehyde is added to paint as a binder. Although it is also present in the environment in low levels, and is even produced in the body after the breakdown of alcohol, exposure to acetaldehyde off-gassing can cause irritation of the eyes, skin and respiratory tract. Acetaldehyde is also a specific inducer of airway hyper-responsiveness in asthmatic patients.

Mercury

Phenylmercuric acetate is used as a preservative to prolong the shelf life of paint by inhibiting the growth of bacteria and fungus in water-based paints. In one particular published case, a child exposed to paint fumes in his home for 10 days was hospitalized with acrodynia, a form of mercury poisoning. A follow up study investigated homes painted with the same brand of paint and found increased mercury concentrations in the urine of inhabitants. The particular brand of paint contained 2 ½ times the EPA recommended limit for mercury. Phenylmercuric acetate has been banned for use in paint in several markets including the European Union and the USA.

PGE

Water based paints can contribute to a lower overall VOC exposure, however a study in 2010 showed a correlation between PGEs (propylene glycol and glycol ethers) and greater risk of developing asthma and allergic diseases. PGE is a VOC that has a lower volatility than other VOCs, and still performs very well as a solvent. For this reason it can be used in water based paints in order to reduce the overall VOC levels, but nevertheless has its own exposure concerns.

Significant innovation has occurred in the



paint sector in the last decade, including better formulation technologies and new additive options. These have facilitated the development of more sustainable paints that can perform on par with traditional solvent based products.

The production of more sustainable, 'healthier' paints has been in response both to consumer pressure, and tighter regulations around the VOC content of paints. Following application, paints can continue to emit VOCs as they dry. Standardised testing for the determination of the VOC profile of paint, measures emission at specified time points eg 24, 48 and 96 hours. While most people would ventilate a room well while they are painting, ventilation may be required for a period of time after the paint has actually been applied.

Several programs exist that test paint and provide a certification mark, based on the paints' compliance with their testing standard. As well as determining relative safety, these certification marks may also measure performance of the paint.

Green Seal

The Green Seal Certification for paints assesses these products on the basis of environmental impact. It includes testing for performance, health and



environmental requirements, end-of-life management, packaging and labelling

requirements. In terms of health aspects, there are a range of chemicals that are banned, and limits are defined of VOCs in the paint product, as well as once applied and emitted.

UL Environment – Greenguard

Greenguard certification is primarily focussed on promoting healthier indoor environments and was first established to assist EPA

purchasing decisions. The Greenguard certification for



paint, tests for total VOC levels in the paint, as well as emissions over time. This standard is primarily focussed on air quality and does not measure performance characteristics.

Scientific Certification Systems (SCS)

The SCS Indoor Advantage Gold is also focused on indoor air quality. Compliance with this certification standard is measured based on indoor air quality modelling and VOC emission over time. Similarly to the UL Environment standard, the SCS Certification does not address performance characteristics of the paint.



asthma & allergy friendly®

The asthma & allergy friendly® Certification Program is operated by Allergy Standards Ltd in collaboration with the Asthma and Allergy Foundation of America, Asthma Canada and is also operated internationally through a global certification mark. Paint certification is based on the impact on the indoor environment for those suffering from asthma and allergies. The programme assesses



the chemical constituents of the paint for toxins and allergens, as well as testing VOC emissions over an extended time course. Finally the physical performance characteristics are measured to ensure the quality of the product.

tesa® builds on its quality reputation

tesa Easy Cover® is a 2-in-1 masking tape and protection film for large area masking with a dispenser for easy application, available in three practical sizes: 17m x 2.6m, 33m x 55cm and 33m x 1.4m.

Designed specifically to protect against paint splashes, spraying and enabling clean paint edges, tesa Easy Cover® comes complete with a practical dispenser and integrated cutter;

adapting ideally to protect any area inside. The statically charged beaded film combines a plastic foil with the latest in film technology, enabling the slowing down of paint drops and providing 7-day residue free removability. The high-quality masking tape also offers good adhesion and can be pulled off easily as soon as the paint protection layer has served its purpose.

Protecting large areas from spraying and accidental colour splashes is key to fast and easy painting and renovating. Using a high-quality protective film not only speeds up work considerably but also prevents damage to valuable carpets, furniture, wallpaper and electronic devices.

Download the Professional Decorator App:



tesa® PROFESSIONAL

FOR RESULTS YOU BUILD YOUR REPUTATION ON

2-IN-1 LARGE AREA MASKING <
STATIC CLING <
PROTECT WALLS, FLOORS AND FURNISHINGS <



 tesaUK

 tesaUK

 tesaUK

 @tesaUK_tape

tesa.co.uk/craftsmen

tesa Easy Cover® in 3 simple steps

Pull tesa Easy Cover® out until the width of the area requiring protection is identified. Tear away the required amount of film using the dispenser.



Gently apply and press the film down, affixing directly above the area requiring protection.



Pull the protective film down to guard against splashes. Carry out paint application and once satisfied with application, remove film to reveal clean paint edges.



The voice *of colour*



Settling on a colour scheme can sometimes seem overwhelming for customers.

But, with the right tools and knowledge on the latest shades and trends, you can provide a valuable service in helping them achieve their colour goals.

Here, Charlie Stafford, Johnstone's Marketing Manager, explains how Johnstone's Trade is helping professional painters and decorators advise on colour.

Every customer has different wants and needs when it comes to colour, and that can be anything from how to follow the latest trends to simply finding the perfect shade of their favourite colour. For painters and decorators being faced with such a broad range of colour queries, it's helpful to have the right tools at hand to help customers to make their colour choices easily.

Sharing Colour Trends

When it comes to colour, Voice of Colour, available exclusively through Johnstone's Trade, and developed by its parent company PPG's global colour experts, contains more than 2,000 specially selected shades that work together across walls, ceilings and trim to complement

each other. Each year the colour team meets to create an annual trends guide, bringing together insight from around the world and across industries to form four key themes and colour collections that resonate with customers.

The Voice of Colour palette and curated themes are also the basis of our new inspirational colour card, making it easier for professional painters and decorators to share the latest trends with customers.

The four trends featured on the colour card reflect the 2018 Voice of Colour themes: The Retreater, The Dream Weaver, The Commoner and The Brave.

The core colours of The Retreater theme are a mix of calming tones, ranging from pale yellows to earthy browns and stone

"The closest thing I've seen to a spray finish from a roller"

Decorating forum user

ProDec
ADVANCE



**Fused Fibre
Technology**

- ✓ **Lint free ultra-smooth finish**
- ✓ **Snap close airtight storage bag**
- ✓ **4", 9" and 12" sizes**



**PERFORMANCE
GUARANTEED**

OR YOUR MONEY BACK*

*see prodec.uk.com for details



greys. Recommending colours from this palette will help to offer customers a selection of tones that create a peaceful and tranquil space.

The Dream Weaver collection is ideal for customers looking for a bold and more daring scheme. The palette features a number of bold statement colours, including vibrant pinks and contrasting earthy tones, that can all make a big impact.

The Commoner palette is made up of primary reds and blues, classic whites and earthy greens, and should be recommended to customers who are looking to develop a simple but timeless space.

The final theme is The Brave – a strong, modern palette made up of rich browns, greys and blacks, that can be mixed with accent tones to help create a glamorous and sophisticated feel.

A Well-Balanced Scheme

While taking inspiration from trends is a great way for customers to make decisions on colours, they can still find it challenging to create a well-balanced scheme. That's why we've developed the 60:30:10 rule – a simple and reliable ratio that makes it easy for professional painters and decorators to advise customers on achieving the perfect colour balance.

The ratio comprises 60% main colour to be used for main walls, 30% secondary



colour for feature walls and ceilings and 10% accent, bold or strong colours that are ideal for trim and skirting. If the customer isn't confident they've made the right choice, this handy rule is a way to help them make the move toward a finish they'll love.

Colour Tools

As well as using the trends and 60:30:10 rule to support customers' colour choices, there are also practical tools that have been designed to ensure professional painters and decorators can add a valuable service when choosing shades.

The Johnstone's Trade ColourBox room painter enables painters and decorators to digitally paint a room in the latest colour trends from the Voice of Colour palette – giving them and their customers a first-hand visualisation of the end result.

Meanwhile, the ColourMatch Service helps customers find the best colour for them by matching any item, from a lampshade or cushion to a sample of their favourite wallpaper or a plant – whatever it is, we can scan and match it. The colours are all available in the Johnstone's Trade range, ensuring professional colour accuracy in high performance coatings no matter what the job.

To learn more about the Johnstone's Trade colour tools, including the Voice of Colour palette, and request a colour card, visit: www.johnstonestrade.com/colour

“

Just started a big wallpapering project and am concerned this will happen...



TOM THE DECORATOR

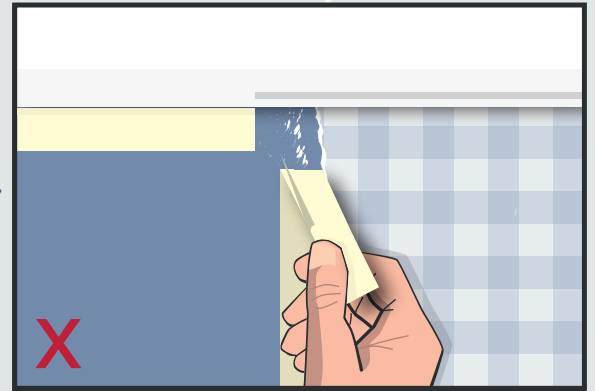

”

Use our **PURPLE** tape it's low tack so will not pull off the new paint or leave a residue behind.

- For thin and slightly textured surfaces
- High moisture resistance
- Thin Washi paper for sharp flat lines
- Removes cleanly leaving no residue

“

Oh no I've used masking tape on my customer's door & woodwork & this happened...

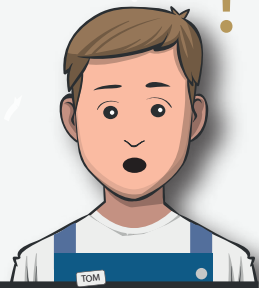

TOM THE DECORATOR

If you'd have used our **GOLD** tape it's low tack so will not rip the new wallpaper or leave a residue

- Thin Washi paper for sharp flat lines
- Removes cleanly leaving no residue
- High moisture resistance
- Strong tear-resistant paper

”

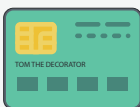
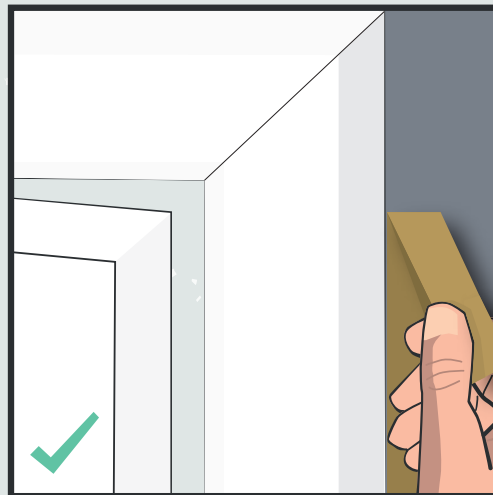
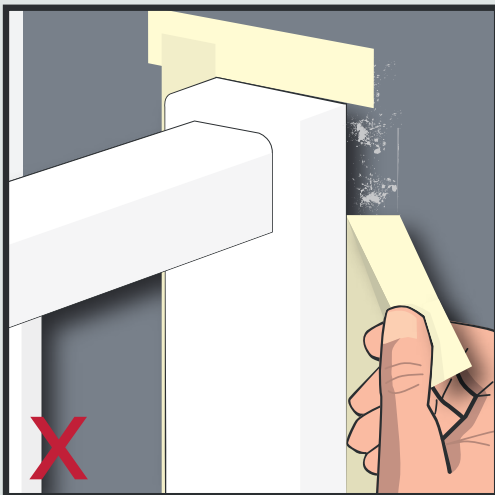

You should use our **PURPLE** or **GOLD** painters tape it will save you time and money.

Decorating solutions

from Axus Decor

OLFA Wallpaper Cutter



The OLFA Wallpaper Cutter has been specifically designed to cut wallpaper.

It glides effortlessly through wet/pasted paper without any snagging or tearing.

The Excel Black Ultra Sharp Wallpaper Blade has been developed with a 65° angle, which ensures that the sharpest point of the blade meets the paper when cutting against a wall. The snap-off blade is sharpened over a wide angle resulting in unparalleled sharpness and the 12.5mm width offers more stability than a standard 9mm blade. It has been made thinner (0.25mm) than all other blades in order to achieve clean cuts and invisible joins when splicing.

The cutter features an auto-blade lock which stops unwanted blade retraction.

The small anti-slip ridges on the sides of the cutter allow you to confidently apply pressure with your index finger. The OLFA Wallpaper Cutter also comes with a built-in pocket clip/ blades snapper making it ideal for any wallpapering job.

Brewers *brief*

Protective Coatings Helpline

Protective coatings can often be complex and so Brewers have created a dedicated helpline for customers to access expert advice to ensure you get the right product for the job. The free helpline offers support with specifications and high performance or specialist coating queries. Plus, if needed, manufacturer site visits with written protective coating specifications can be arranged free of charge. The helpline can also provide advice on spray equipment and set up spray demonstrations in your local area.

Marc Borzoni, the dedicated protective coatings helpline specialist, has over 30 years experience in the industry, starting as a painter in the mid 80's. Marc joined Brewers a few years later and has since qualified as an Institute of Corrosion Painting Inspector reaching ICorr Level 2, working within the Protective Coatings team.

"This service is an essential part of our core aim to offer the best service to our customers. Protective coatings can often require detailed information and specification and so I am here to provide advice and assistance to simplify the process and ensure you get the right product for you or your clients needs. I enjoy a challenge, so please feel free to give me a call for any PC or spray query however big or small."

If you need help on specifications, specialist or high performance coatings or spray machines, give Marc a call on 01793 644837.

Start every job with ZipWall®!

***Protect
client property
– and freshly
painted surfaces –
from dust***



Spring-loaded poles up to 6,1 m high



Easy to set up

Save time and money

Improve safety

***See how
it works at
zipwall.co.uk***

***Set up a dust barrier in
minutes!***



FOR THE RED, WHITE AND BLUE VAN MAN.

VIVARO
WITH 4 YEARS

**0% MINIMUM
18% DEPOSIT
APR PLUS FULL VAT**

WARRANTY

**ROADSIDE
ASSISTANCE**

FREE SERVICING



SEARCH VIVARO OFFERS

Official Government Test Environmental Data. Fuel consumption figures mpg – 40.9 (6.9), Extra-urban: 42.8 (6.6) – 51.4 (5.5), Combined: 40.9 (6.9) – 47.0 (6.0). CO₂

Model shown Vivaro Sportive. Business users only. Conditional sale. 4 years 0% APR with minimum 18% deposit (plus VAT on total transaction price). Finance provided by Vauxhall Finance, CF15 7YT. Subject to limit has been exceeded, whichever occurs first. 4 years Roadside Assistance provided by the AA including Roadside, Home Service, Relay, Onward Mobility and European Assistance. 4 years scheduled Servicing schedule. The offer includes Vauxhall's standard Customer Care Commitment of a 1 year unlimited mileage manufacturer's warranty and a second and third year manufacturer's warranty with a 100,000 mile accordance with the manufacturer's servicing schedule. The offer also includes Vauxhall's standard Customer Care Commitment of 12 months Vauxhall Assistance from first registration. Terms and conditions excluded. Available at participating Retailers only, may not apply to all Retailer stock. #Fuel consumption information is official government environmental data, tested in accordance with the relevant EU directive. right to change, amend or withdraw this offer at any point in time. Correct at time of going to press.



(litres/100km) and CO₂ emissions (g/km). Vivaro Panel Van range: Urban: 35.3 (8.0) emissions: 178 – 155g/km.[#]

status, eligibility, terms and conditions. Applicants must be aged 18 or over. 4 years Warranty up to 100,000 miles for Vivaro. The warranty will expire when the vehicle has reached either 4 years or when the mileage free for up to a total mileage limit of 100,000 miles for Vivaro. Offer includes routine service parts and labour, but excludes wear and tear items and other maintenance items not covered under the routine service Vivaro limitation. Please note, the additional 1 year warranty on Vivaro vehicles applies to the base vehicle only. The warranty excludes wear and tear and serviceable items, and the vehicle has to be serviced in apply, ask Retailer for details. Available when purchasing a new Vauxhall Vivaro ordered between 3 July and 1 October 2018. All offers available to small businesses 1-24 units (purchase only). All other customers are Official EU regulated test data is provided for comparison purposes and actual performance will depend on driving style, road conditions and other non-technical factors. Vauxhall Motors Limited reserves the

National Painting and Decorating Show 2018 RICOH ARENA, COVENTRY 27/28 November *Covers Everything!*

For professional decorators, contractors, merchants and stockists, November 27 is the time and Coventry's Ricoh Arena is the place. That's when the National Painting and Decorating Show – the annual trade event that has the entire decorating sector covered – opens its doors for its annual two-day run.

From product innovation to trusted best sellers, the 2018 show will display the latest trends, textures and techniques making decorating headlines.

Product launches, hands-on demos, theatre sessions, show-only deals, free samples, how-to information – every year this show buzzes with competitions, raffles, prize draws, sporting challenges and celebrity guests.

Visitors will discover profitable, and potentially lucrative, opportunities to meet exhibitors face-to-face, and exchange ideas and solutions with like-minded decorating pros.

So what are you waiting for? Pre-register today for the major industry event that presents all things decorating – from paint and wallpaper, to prep tools and applicators, to colour trends and time-saving techniques.



4-PAGE PREVIEW STARTS HERE!

See You There!

Location, location, location!

With its on-site hotel, restaurants and bars, the show venue is easily accessible by road, rail and air: a two-hour drive from 75% of the country; plenty of on-site parking; Birmingham Airport a short drive away; and an on-site train station providing an hourly service between Coventry City station and Ricoh Arena.

Be prepared!

Trimaco will showcase their range of products for jobsite prep and protection, including heavy duty temporary floor and surface protection, dust containment products, dust sheets and Easy Mask® masking products.



FREE TICKETS @ www.paintshow.co.uk

SPRAYZONE

New show feature area will take the mystery out of spraying

A brand new feature area at this year's event will give visitors a hands-on opportunity to hone their paint spraying skills on a wide range of spray equipment. **SprayZone** is designed to complement the demonstrations by individual spray equipment manufacturers which have always been very popular with visitors.

Whether already familiar with spray painting or complete novices, visitors will be instructed by demonstrators in the proper and safe use of several different types of equipment.

These will include:

- Conventional sprayers ● HVLP/XVLP/LVLP ● Airless
- Airless Assisted ● Spray Plaster

15-minute sessions will run throughout the day demonstrating the benefit of each kind of machine and the techniques for using it. In addition, advice on health and safety will form a strong element. As well as **SprayZone**, two special MasterClass theatres will feature demonstrations across a wide range of products.

A touch of luxury by Avko

Avko Interior are returning to the event this year to demonstrate their luxury textured feature wall paint and smooth matt emulsion.

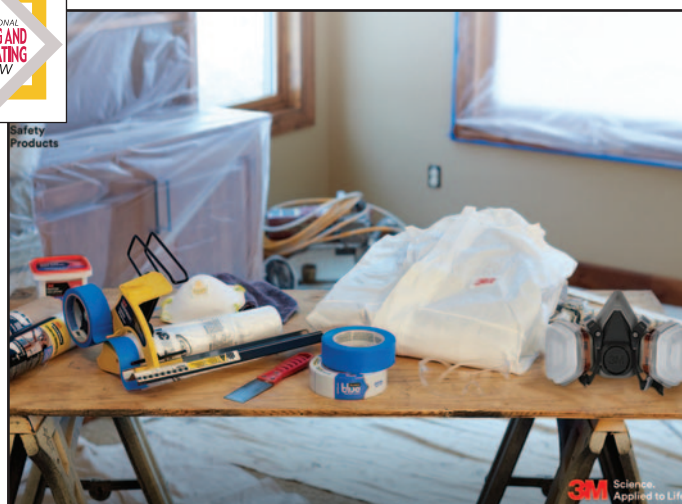

Get it right first time with 3M

It's their job to help you do yours — faster, easier, better and safer. Designed with the pro in mind, 3M claims to give you the tools you need to get the job done right the first time.

New from PlastiKote

PlastiKote will launch a new one-stop-shop range for the decorating trade. You can find out what all the fuss is about on Stand 78.



ENTRY TO THE SHOW IS FREE. REGISTER TODAY!

Win yourself a sprayer

Visit Coo-Var on stand 2 where there will be plenty of demonstrations, product samples, goodie bags and a new product launch — plus your chance to win an airless sprayer worth over £250!



New Multi Wipes from StortEskens

StortEskens, the independent tinting service providers, are launching Multi Wipes into the retail market — essential for the effortless removal of paint, ink, grease, glue, oil and sealants from hands, tools and surfaces.



Grab a sample

Join OSMO on stand 46 and speak to their experts about best practices when using Osmo UK products — and even grab yourself a few samples while you're there!

You can Trust Little Greene ...

Little Greene will be exhibiting their latest paint collection, a refreshing new palette of authentic National Trust paint colours available in all Little Greene finishes.



Deltec Tape: never miss an evolution!

Get the best finish ever with Deltec Tape, which ensures no paint bleed or glue residue, plus six months UV resistance. 100% success guaranteed because a pro knows!



Are you a Member?

The UK's largest trade and employers' association in the painting and decorating industry — the Painting and Decorating Association — has members nationwide, and has been committed to encouraging best practice across the sector since 1894.



Specialist advice from Sprayman

Sprayman UK are specialists in the painting and decorating industry, and one of Graco's largest European distributors. Visit them for expert advice and view premium products from world leading manufacturers.

Ultimate cleaning solution



Interactive exhibitor



At this year's event, Ciret will showcase their recently launched Masq range, along with a variety of products being launched exclusively at the show. Visit stand 96 or join in their interactive masterclass.



The tale of the tape ...

In their 11th year at the show, Tesa will be showcasing their range of tapes used by professional painters and decorators, to help you achieve the best results.



Each day of the Show the first 1,000 visitors will receive a complimentary product-packed DecoBag!

Box of Tricks

The Timbabuild Starter Kit Box from Chemfix includes repair resin, rapid adhesive, EWS epoxy primer, Timbaglaze sealant, and more! Visit the stand to find out more about this limited period offer.



Diamonds from Dulux

Visit the Dulux Trade stand, home to the highly durable Diamond range and award-winning Dulux Academy. Learn how Dulux Trade can support your business - and of course, meet the Dulux dog!

Simply the best

Visit stand 48 to pick up your free sample of Bedec (MSP) Multi Surface Paint and see examples of its capabilities.



Graco's latest sprayer demo



Following the successful Ultra Handheld, and TurboForce II launches, Graco will demonstrate the latest 110V version of the APX Texspray unit which complements the market-leading Mark V plaster sprayer. Go to stand 33.

Paint For Professionals

On stand 26, MagnaMuros will launch the Paint For Pros range, which combines high quality finishes with ultimate performance. The range includes Sketch, Magnet, Projection and Blackboard Paints, as well as a Magnet Plaster.



One Can do it with Bradite!

The Bradite stand will feature the launch and product demonstrations of One Can, the first anti-corrosive, stain-blocking, water-based primer and finish which can be used on all manner of substrates.



Help is at hand from Farrow & Ball

Visit colour experts Farrow & Ball to discover their distinctive paint colours and finishes, as well as handcrafted wallpapers. The team will be on hand to answer questions and demonstrate the paints in action.





Here are just some of the exhibitors and brands you can see at this year's event



3M
AJ Systems
Akcali
Alliance Workforce
Aristospray
Artex
Avko Interiors
Barrettine Products
Bedec
Benjamin Moore UK
Big Wipes
Bradite
Brewers Decorator Centres
Ciret
Coleman Bros
Colour Genie/Tide
Coo-Var
Craig and Rose
Crown Decorating Centres
Crown Paints
Deltec Tapes
Dexter Workwear
Dripless Inc
Dulux Academy
Dulux Decorator Centre
Dulux Trade
Dupre Minerals
Ecoezee
Farrow & Ball
Festool
Flex Power Tools
Graco
Gray Campling
Go Paint
Indasa
Jakob Hardi
Isomat
Kolorbond
Ladder8rix
Liberon
Little Greene Paint Company
Lyte Ladders and Towers
MagnaMuros
Make Good
Mirka Abrasives

Muraspec Wallcoverings
National Abrasives
Osmo
Packexe
Painting and Decorating Association
Painting And Decorating News
Painting Craft Teachers Association
Painttech Training Academy
Pioneer Brush
PlastiKote
Polyseam
Prodec
Professional Painter and Decorator Magazine
Q1 Tapes
Rainbow Chalk
Repair Care International
Roll Roy
Rupes
Rustins
S&S Home Supplies
Sherwin Williams
Shurtape
Sia Abrasives
Silk Plaster Group
Smart Strip Paint Removal
Sprayman Uk
Sprayzone
Staalmeester
StortEskens
Suretherm
Teknos Pro
Tembe DIY and Building Products
tesa
Tikkurila
Timbabuild Epoxy Wood Repair
Tradepoint
Trimaco
Univar Specialty Consumables
Uniwipe
Wagner
Vliegenthart
Werner
Vista Digital
Zipwall

No more mould

Perfect for housing associations, landlords and student accommodation for use on bathrooms, kitchens and cold walls, Suretherm thermal anti-condensation paint helps prevent mould and it still works when overpainted!



Brexit-free zone

A Brexit free zone! Direct from the USA, Dripless, Inc will demonstrate the futuristic, super strong, lightweight and dripless ETS3000EL caulking gun. Visit the stand and take one home!



Time for a coffee?

There's so much to see at the National Painting and Decorating Show, you might welcome a short break from time to time to recharge your batteries and plan the rest of your visit. Just drop in at the **CoffeeZone**, sponsored by Crown Decorating Centres.



MasterClass takes to the stage

Sponsored by Packexe, our two MasterClass theatres will again present practical presentations and demos every 30 minutes. So take a seat, rest your feet and watch the experts in action as they reveal plenty of tricks and techniques of the trade.



Go to:
www.paintinganddecoratingnews.co.uk
for the very latest industry news

Visit www.paintshow.co.uk for FREE tickets!



Workwear for women

With more and more women working in the trades, it seems logical that they should have their own workwear.

Hoydens Workwear is a start-up based in Sheffield that has the aim of addressing the workwear problems of women who work in trades or on site. For instance, Hoydens professional trousers can be worn comfortably all day because they are specifically designed for a women's body shape having extra space around the hips and thighs with stretch fabric to give additional flexibility.

Annie Bowman, a painter & decorator and designer of the range says "The fabric of the trousers has been chosen because it has great resistance to abrasion, chemicals and heat, making them very hardwearing

and longer lasting. Workwear for men has vastly improved over the last few years, and although there are alternatives for women out there now, there are always niggles. Typically, women are unhappy with the fit around the hips and waist and the lack of options on leg length of the available products on the market. These issues make them feel less professional in front of other colleagues and can lead to a drop of self-esteem".

Hoydens come in women's sizes 8-18, three different leg lengths, making it easier to order the right size, and in black, grey and of course, white. As an alternative to holster pockets, Hoydens

came up with Hoysters – optional attachable pockets that can be placed at the sides, or a large pocket at the front. They easily clip off at the end of the day and can store tools specific to the task being undertaken.

Hoydens will be asking everyone who buys the trousers for their feedback as they want to make sure as many women as possible have a fit that is right for them. Future designs will include different fits of trousers and more features such as knee pad pockets. Work tops and jackets to accommodate the bigger bust are planned too.

Hoydens.co.uk

THE LITTLE ONE-HAND SANDERS

with speed control and PES filter cartridge in set



SMALL SURFACES AND EDGES

DELTA SANDER

ODE 100-2 set

- 200 watt
- 8000-13000 rpm
- 16000-26000 opm
- Orbit 2 mm
- Only 1.2 kg
- Including sanding paper 1 x P 80 and 1 x P 120
- External dust extraction Ø 27 mm



CORNERS AND EDGES

PALM SANDER

OSE 80-2 set

- 8000-13000 rpm
- 16000-26000 opm
- 200 watt
- Orbit 2 mm
- Only 1.2 kg
- Including sanding paper 1 x P 80 and 1 x P 120
- External dust extraction Ø 27 mm



ROUND SHAPES

RANDOM-ORBIT SANDER

ORE 150-5 set

- 350 watt
- 5800-10000 rpm
- 11600-20000 opm
- Orbit 5 mm
- 2.1 kg
- Including sanding paper 1 x P 80 and 1 x P 120
- External dust extraction Ø 27 mm



SAFETY VACUUM CLEANER

VCE 26 L MC

- 1250 watt
- 3600 lpm
- 21000 Pa
- Container Volume 25 l / Wet vacuuming 16 l
- 8.4 kg

VCE 33 M AC

- 1400 watt
- 4500 lpm
- 25000 Pa
- Container Volume 30 l / Wet vacuuming 17 l
- 15.2 kg



GIRAFFE®

GE 5

- 500 watt
- 1100-1650 rpm
- Ø 225 mm
- Length 1520 mm
- 3.9 kg

For more information please contact

Stuart Colclough

P0 Box 192, Darlington DL1 9FN
Phone +44 (0) 1 325 741793
Fax +44 (0) 1 915 045133
Mobile +44 (0) 77 909 90682
uk.sales@flex-tools.com

FLEX
Das Original

Drawing & painting faux bricks

By Lynda Bergman

Recently, I've been working for a builder who is building Orleans style house for a client. The builder had one area that bothered him and couldn't decide what to do with it.



Finally, he had an idea and called me to ask if I could paint faux bricks for him in this area. So, I did paint faux/trompe l'oeil bricks for him. To the left are three walls with bricks. Can you tell which two walls are real and the one that I painted?



Ok, which one?

Alright, I'm sure you've guessed it. The butler's pantry was very plain and the builder wanted me to paint the faux bricks to blend with the other two walls. When you're standing in certain areas in the big living room you can see all three brick walls at the same time. It was important to make them look the same.

I'm very happy with the way they turned out. Everybody was saying, "oh that looks good, you did it," and that made me feel good. The builder helped me with critiquing the grout lines, and together, WE DID IT!



TUTORIAL

First, I used dry spackling. With a broad knife and my finger I lightly textured the area.

I picked out colours to match the existing brick and mortar colours. I painted the grayish grout color over the whole area as my base coat. When that dried, I used my brick stencil to get the structure going.

Next, I used a regular brush to stencil the orange brick.

Then, I used a brush to paint on and a rag to rub out raw umber, off white and black. It took a while to work on each brick and make them different from each other. Last, I went back with a brush to paint the grout lines a little wider. As the paint was wet, I wiped with a rag and smudged areas onto each brick to match the existing real brick walls.

At the very bottom and at the very top I had to make my own bricks because the stencil wouldn't fit in those spots. The bricks are so uneven it's very simple to do. In the corners, I lightly brushed some raw umber so it shadowed, making it look more three dimensional. I think anyone could do this. You could paint the wall behind fireplaces, the backsplash under kitchen cabinets, a bedroom wall or any place you wish you had bricks. You can use any color for your bricks and mortar.



the varnish experts

a great new start to a perfect finish



check out
our range
of finishes

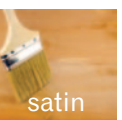

POLYVINE

find us in store or online at polyvine.com

On test:

Circular Saws

A circular saw saves time and effort and with very little practice, easy to get an accurate cut whether cross cutting or ripping.

We gathered together five easily obtained examples, put them through their paces and this is what we found.

Screwfix 36727 Evolution Range 1B

Guide Price	£69.99
Wattage	1,050
Voltage	110
No Load Speed	3,700rpm
Blade Diameter	185mm
Weight	4.4Kg
Cutting Depth Capacity	90° 60mm



Screwfix supply this low cost 110 volt saw for use on sites where they insist on low voltage for safety. Range of angle of cut from 0 to 45 degrees. Comes in a cardboard box with 2.5 metre cable and a Parallel Guide. You'll need a transformer though and we all know how weighty they are. Screwfix also supply a 230 volt version.

Clarke International CCS185B

Guide Price	£50.39 Machine Mart
Wattage	1,200
Voltage	230
No Load Speed	4,800
Blade Diameter	185mm
Weight	3.95Kg
Cutting Depth Capacity	90° 65mm, 45 44mm



Low cost circular saw from Machine Mart, easy to find in one of the many of their stores about the country. Comes in a cardboard box and is supplied with 2.5 metres of flex and a parallel guide and general purpose blade. No transformer required.

Wickes141159 1300w Circular Saw

Guide Price	£49.99
Wattage	1,300
Voltage	230
No Load Speed	4,700
Blade Diameter	185mm
Weight	3.6Kg
Cutting Depth Capacity	90° 65mm, 45° 45mm



Low cost, high value circular saw, supplied in a cardboard box and has a parallel guide, laser guide and 3 metres of flex. Sports a rubberised 'pistol' grip handle and a chunky top handle.



CLEAN YOUR ACT UP!

Double Sided | Absorbent | Powerful | Kind to Hands

Now Available in Handy Packs of 40



www.hippoproducts.co.uk





Makita 5017RKB

Guide Price	£209.99 Machine Mart
Wattage	1,200
Voltage	230
No Load Speed	4,800
Blade Diameter	190mm
Weight	5.5Kg
Cutting Depth Capacity	90° 66mm, 45° 46mm

Supplied in a plastic case, has an unusual 'dustless' integral dust collector, Makita claim up to a 93% dust retention. Usual high Makita quality but then at comparatively high Makita price. A powerful tool that should last years and years.



Makita DSS611RMJ

Guide Price	£279.96 Anglia Tool Centre
Voltage	18
No Load Speed	3,700
Blade Diameter	165mm
Weight	3.2Kg
Cutting Depth Capacity	90° 57mm, 45° 40mm, 50° 36mm

Makita say this model was a low cost variant of the DSS610, what you don't get the LED job light, Positive stop at 45°, the blower function and the electric brake. What you do get is a powerful circular saw without being tied to a flex and a power source. No worries about needing 110v tool on site but you do lose a little depth of cut. A lightweight for a cordless saw.

The PaintShed

The trusted choice for trade

Price Guarantee | Free Delivery

All of your favourite brands
under one roof

CROWN

Dulux

Macpherson
TRADE PAINTS

JOHNSTONE'S

JOTUN
DEMI
DEKK

Leyland
Trade

Save on your next job at www.thepaintshed.com



The Wagner logo is located in the top left corner. It features a black triangle above the word "WAGNER" in a bold, black, sans-serif font. The entire logo is set against a yellow rectangular background.

WAGNER

WE JOIN FORCES.

HeavyCoat 750:
Next Generation Airless

HydraStroke
TECHNOLOGY™



wagner-group.com



The New Citroen Relay arrived for me to put through its paces with virtually every extra the Citroen offered. Its fun using them but one does wonder if many bosses would be inclined to spend the extra. There are some that can and will in the long run save money. The rear facing camera will save the odd expensive and time wasting effects of a bump. The GPS will save a lot of time and map reading and asking the way for the driver.

The Relay has good design features that will save on repair bills. The front bumper for instance is in three parts so an unfortunate minor 'coming into contact' will not mean the replacement of the whole part.

In the driver's seat you get an excellent commanding view of the road with superb double rear view mirrors. The seat is reasonably comfortable and adjustable for most shapes of drivers. Steering is light and responsive and the column stalks give you as

usual the indicators, lights, cruise control, speed limiter and wipers.

On the steering wheel you can alter the volume of the entertainment and phone. I found the gear change a trifle lumpy but its position was good. The cabin sports 13 storage spaces and cubby holes. Over the screen is a cab wide shelf, the back of the middle seat can be lowered to reveal a table for your lap top. On top of the dash is a 'lectern' where you can clip the paperwork, delivery note etc.

There is not an automatic version just the six speed box used throughout the range, so those with auto only licences need not apply. The

handbrake is on the right of the driver's seat, not the most common place but it soon becomes familiar.

There are three seats in the Relay. The middle one can be eliminated and a nice full sized one, its a no cost option, fitted for those who only carry two staff and travel long distances. For those sitting in the middle seat there is an assembly of cup holders near the floor where the middle seat





STRONGER
THAN
STAINS



Johnstone's StainAway. Stronger than stains.

Johnstone's StainAway is an innovative all in one wall and ceiling paint that isolates even the most persistent stains in one coat. The Stain Blocking Technology permanently isolates and covers stains including smoke damage, nicotine damage and water stains, saving you time by acting as a primer and finish in one. Visit your local Johnstone's stockist to put the product to the test.



PAINT TO BE PROUD OF

passenger would like to put their feet and would make for an uncomfortable ride.

On the motorway I found that one could soon get into trouble as the 160hp diesel is very powerful and the 70mph limit can be easily exceeded. On the test Relay there's an alarm that tells you if you are too close to the lane markings. This feature can be switched off where the lanes are narrow in the case of road works as there incessant sounding off can be irritating.

The main purpose of a van is to carry stuff and payload capacities across the range from 1,115kg to 1,900kg and volumes of 8 to 17 cubic metres. The load space in the Relay is one of the widest with 1,422mm between the wheel arches and 1,870mm load space width. A Europallet fits nice and flat and can also be loaded through the 1,250mm side door.

The Relay uses the same underpinnings as the Peugeot and Fiat offerings although Fiat have a different range of engines. All in all a class act but it has to be said the Relay lacks the street cred of Ford's Transit or the Sprinter from Mercedes.

Basic 'On the Road'

Price £29,895.00

As Tested £36,924.00

Specification:

Engine Type	4 Cylinder Diesel Euro 6
Capacity	1997cc
BHP	160 @ 3,750rpm
Torque	350Nm @ 1,750rpm
Gearbox Transmission	6 Speed Manual

Performance

Fuel Consumption

Urban	42.2 mpg
Extra Urban	47.9 mpg Basic
Combined	45.6 mpg
Brakes	Discs all round + ABS
Steering	Power assisted
Turning Circle	14.14 (kerb to kerb)

Dimensions:

Overall Length	5,998mm
Overall Width	2,508mm (Including Mirrors)
Height	2,522mm
Gross Vehicle Weight	3,500Kgs
Kerb Weight	1,925Kgs
Payload	1,525Kgs
Max Trailer Weight Braked	2,500Kgs
Tyre Size	215/70



See us at
the Painting &
Decorating Show
Stand 26

**PAINT
FOR
PROS**

*Power to the
professional.*

Developed by Specialists & Professional
Painters – Products to Trust.

Professional Performance Paints – a wide range of specialist paints including Magnet, Sketch, Projection & Blackboard.

TO MAKE AN ENQUIRY PLEASE CONTACT US TODAY

T: 01282 505988 E: sales@magnamuros.com
www.magnamuros.com



reddot award 2016
winner





MT-1/WP

Wallpaper Cutter

*The blade has been developed
with a unique 65° angle,
researched to be the ideal angle
for precise wallpaper cutting*

**Specially designed for
wallpaper cutting**

**No snagging or tearing
of wallpaper**

**Comfortable and
easy to use**

OLFA

STOCKIST INFO

020 8204 1422

info@axusdecor.com



/axusdecor

www.olfatools.co.uk

Be colour sure with Sadolin



Sadolin is taking the guesswork out of selecting the perfect shade for wood with the launch of its new colour testing sample pots - now available to buy from the majority of stockists.

The 250ml sized sample pots will aid the choice of colour across six of Sadolin's best-selling translucent and opaque products and

are the ideal way for professional decorators and homeowners alike to try one or more colours before making a purchase.

Customers will be able to purchase a sample pot of Sadolin Classic to test any of the 40 plus translucent tintable colours available in the Sadolin Classic, Sadolin Extra, Sadolin Quick Dry and Sadolin One Coat woodstains. Where an opaque finish is preferred, the Sadolin Superdec sample pot will help customers determine which shade to select from more than 280 opaque tintable colours which are available in both Sadolin Superdec and Sadolin Beautiflex.

Choosing colour for exterior wood projects can be a challenge as the natural colour and finish of the wood will affect the colour of translucent woodstains once dry. Applying the same shade of woodstain to two different types of wood can result in a vastly different finish. The most reliable way to determine which colour to use is to try a small sample area first to see how it interacts with the natural colour and grain of the wood substrate.

Sandtex's X-Treme X-Posure

Sandtex X-treme X-posure® formulation endures extensive testing in accelerated and real time weathering conditions, and is proven to offer long-term protection and an enduring high-quality finish. When correctly stored, transported and applied to sound surfaces utilising the recommended preparatory products, X-Treme X-Posure® will maintain the film integrity, provide good colour stability and perform satisfactorily for up to 20 years.

Already tried and tested on a number of buildings across the UK, Sandtex's X-Treme X-Posure® has been specifically formulated for use in even the harshest of weather conditions.

Whatever the weather, it is guaranteed to provide excellent dirt-resistance and colour retention to help exterior masonry keep that 'just decorated' look for longer. Thanks to its excellent adhesion and flexible formulation, X-Treme X-Posure® also helps to disguise hairlines cracks in exterior surfaces and stop them from reappearing.

As well as offering long-lasting protection, X-Treme X-Posure® can also offer immediate benefits thanks to its water-based formulation. Touch dry in just 30 minutes and ready to recoat within two to four hours, Sandtex's quick drying masonry paint provides a convenient and cost-effective solution, making it the ideal choice for jobs that require a fast turnaround.



STAIRMATE

PRODUCT ANNOUNCEMENT THE NEW STAIRMATE MK2 BUSINESS OPPORTUNITY

Due to impending retirement an opportunity is available for interested party/company to take forward the all new improved STAIRMATE MK2.

The new version has been redesigned for ease of manufacture and IP rights potential.

The design changes improve on the simplicity of an already great product and is ready to launch for a company wishing to add this established brand to its product range.

Enquiries to Lewsan Ltd

Email: stairmate@hotmail.co.uk

Tel : 01708 473842



...the solution for stairwell access

MIRKA



Mirka[®] LEROS



reddot design award
best of the best 2018

Pure Innovation.

Less than 3.5 kg. 180° flexibility. 100% comfort.



www.mirka.co.uk/MirkaLEROS

Safeguard Stormdry add-ons



Safeguard Europe has augmented its Stormdry Masonry Protection Cream by introducing three additional, aligned products that deliver solutions from anti-graffiti coating to crack bridging and mortar repair.

The new range now comprises Stormdry Masonry Protection Cream, Stormdry XR Mortar, Stormdry AG Coat and Stormdry CB Coat.

Stormdry CB Coat is a water-resistant coating that bridges small cracks in walls, creating a waterproof barrier against rain. Being semi-breathable, it can be used as a top coat for Stormdry Masonry Protection Cream when fine cracking is present – or in areas subject to extreme weather. Its high density initially results in a very slight visual 'satin' change to the surface that fades with time.

Stormdry AG Coat anti-graffiti protection is a permanent water-resistant coating that allows for easy removal of aerosol paint, 'permanent' markers and fly posts. Applicable over already decorated walls, Stormdry AG results in a glossy surface that prevents paints adhering to the substrate and renders them easy to clean.

The final new introduction is Stormdry XR Mortar. It is a polymer-modified mortar that can be used to seal cracks or repair pointing to prevent water ingress, and reduce the possibility of further damage. The perfect wall preparation prior to the application of Stormdry Masonry Protection Cream and able to fill cracks between one and 15mm, it is directly applied to damaged areas using a cartridge gun and cures in about two hours.

Snickers' new stretch clothing

The brand new comfort fabrics woven into Snickers' latest designs deliver enhanced freedom of movement as well as improved ventilation and close quarter mobility. They also mean that the clothes have a slimmer tailored fit for better all-round looks and protection against snagging. With a range of new Trousers, Jackets, Rainwear and Accessories on their way, there's plenty of scope for every professional craftsman and woman to stretch their performance on site comfortably.

So check out these newest designs – the optimal choice for craftsmen and women who need to get the job done comfortably on site.



premill&finish

The perfect finish for any type of decoration

- Adheres to painted surfaces**
- Super fine for a smooth finish**
- Fast setting for early sanding**
- Formulated for plasterboard jointing, surface smoothing, repair and snagging work**

Special prices now available, please contact Wondertex:
01827 254402 | wondertex.co.uk



Extreme Durability For High Traffic Areas



Introducing a breakthrough single-component, scuff-resistant water-based paint for long-term durability and minimal maintenance.

Benjamin Moore®
Paint like no other.®

For stockist information, visit www.benjaminmoorepaint.co.uk/stores

New tapes more than measure up



Known as Roughneck Tough Tapes, these new products benefit from a number of external and internal features. Externally, this includes an attractive and durable, heavy-

duty, chrome plated case as well as a strong belt clip. Internally, they employ a high-performance shock absorbing recoil mechanism as well as powerful blade brake. Based on Auto Brake™ technology, this securely locks the extended blade in place with no slippage.

The blades themselves have a large magnetic double-ended hook which enables easier one-person use. In addition, to make the tape measures simpler to read, they are wider than normal at 27mm in width and feature Roughneck's patented E-Z Read® graduation on the upper side of the blade. This graduation offers both metric and imperial measurements. and has every 1/8" marked with a number. trade tasks quicker, easier or more "

Bosch Rangefinder



For anyone whose work involves distance measurement on work sites, Bosch is offering upgraded performance in the shape of its new Bosch GLM 120 C Professional Rangefinder. In addition to a camera as a viewfinder with integrated zoom function, which solves the common problem of target invisibility, this user-friendly laser measure enjoys all the benefits of Bosch connectivity.

Bluetooth connection with the free Bosch Measuring Master app gives access to a range of useful facilities for recording, processing and sharing information to speed up workflow. The device also comes with GLM Transfer Software which allows simple copying of data and pictures from its own memory to your laptop or PC.

Inability to see the laser spot from a measuring device often results from difficult light conditions outdoors, but even in indoor applications, it can be a problem. The Bosch GLM 120 C Professional Rangefinder, using its 5MP camera as a viewfinder to find and zoom in on targets, overcomes visual issues relating to lighting, long distance, complex surroundings and other factors. Its laser measuring range is up to 120 metres and it works to an accuracy of +/- 1.5 millimetres.

The device's large colour screen (2.8 inches), with flip display, has a familiar smartphone look. Readability from all angles is possible thanks to IPS (in-plane switching) technology, while optical bonding minimises the effects of condensation or reflected sunlight when viewing the screen outdoors.

MADE FOR BUSY AREAS



A HARD-WEARING MATT EMULSION WITH A WASHABLE FINISH. THE STAIN & MOISTURE RESISTANT FORMULA PROVIDES LONG LASTING PROTECTION, MAKING IT IDEAL FOR BUSY AREAS.



T: 0330 024 0313

W: WWW.MACPHERSONTRADE.CO.UK

Macpherson
TRADE PAINTS



No paint bleed



Clean removable up to 6 months



Indoor and outdoor use



Saves time and money

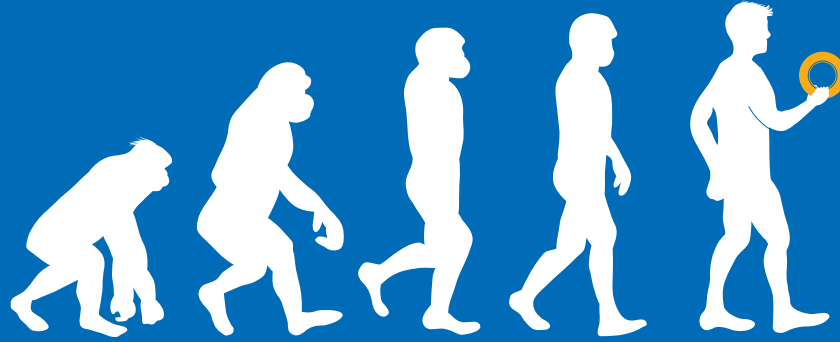

NEVER MISS AN EVOLUTION.

FREE TRIAL PACKAGE!

Deltectape.com/gold-sample

CRÊPE TAPE **VS** DELTEC GOLD

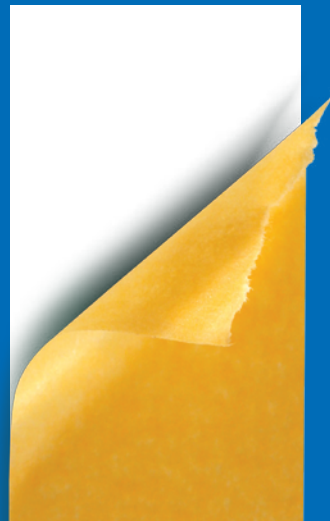

DELTECTAPE

A PRO KNOWS



www.deltectape.com | +31 (0)413 - 24 44 82 | info@deltectape.com

Bond It's tool kit

Bond It has launched a new sealant applicator tool kit which makes it easier for the novice sealant user to good results, every time.

These tools can be used to smooth and shape sealant applied in recessed, flush or fillet joints to leave a more attractive, neat and tidy finish.

The four different size tools can accommodate any joint measuring up to 28mm as well as any angle including 45°, 90° and 180°.

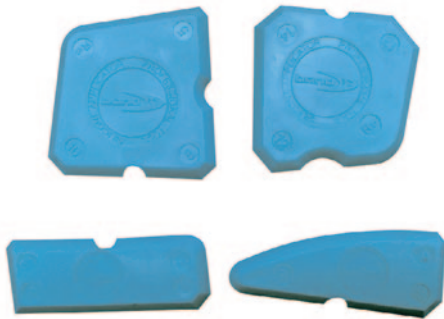

Deltec in the UK

Deltec, the fastest growing tape brand in the Benelux is now available in the UK.

Problems like paint bleed, glue residue, damaged surfaces and tearing when its removed is not a problem with Deltec Tape.

Most popular, Deltec Gold and Deltec Purple are both made from rice paper (washi).

The Gold tape is suitable for use on most common surfaces, both

indoors and outdoors, with no glue residue for up to six months.

The Purple tape is a low tack tape suitable for sensitive surfaces like wallpaper and fresh paint, for indoor use with no glue residue for up to four months.

A free trial package is available.

www.deltectape.com/gold-sample | info@deltectape.com | 0031 (0) 413 - 24 44 82

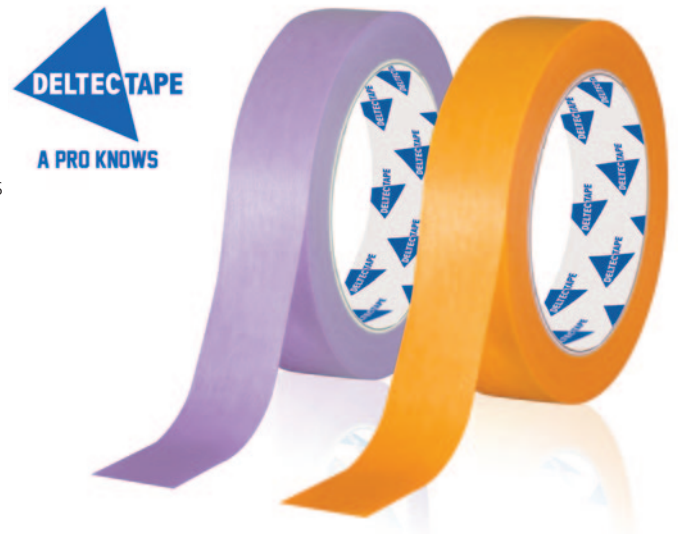

Covers Everything!

National Painting and Decorating Show 2018

RICOH ARENA, COVENTRY 27/28 November

Go to www.paintshow.co.uk for free tickets or call 020 8645 2433



Quality...



HANDMADE IN
THE USA 

Uncompromised

CORONA[®]

web.
tel.
email.

www.coronabrushes.co.uk
0333 20 21 031
sales@coronabrushes.co.uk

Ginkgo wallpaper collection



The new Ginkgo collection from wallpaper designer and artist Elizabeth Ockford for international brand, The Paper Partnership, has a selection of nine designs to choose from, Beryl, Quarry, Garnet, Malachite, Topaz, Morganite, Hatton, Celestine and Pyrite, which are available in an extensive selection of colour ways.

Makita's job site speaker

The new and versatile Makita DMR202 Job Site Speaker with Bluetooth delivers an extensive range of playback options. Powered by the Lithium-Ion range of Makita 18v LXT and 10.8v to 12v CXT slide type batteries, as well as AC power supply, this compact and lightweight speaker delivers 10.0 watts of output from the two-way speaker system. This model also features a 101.6mm woofer and 36mm tweeter.

This intelligent speaker features several new benefits including an LCD panel that displays song titles as well as the singer or band. Conveniently, it can play music in USB Flash Memory overcoming the need to run via a mobile phone, and it has a repeat function that allows the entire playlist to repeat, or to



be song-specific. Additionally, a play at random function can be selected.

The speaker is also equipped with Bluetooth Class 2 to wirelessly connect to your mobile device for playing music with a range of up to 10 metres. There is never a fear of losing signal or running your device battery down as the DMR202 can charge your device and play at the same time, offering convenience, versatility and greater safety.

Knauf launches new jointing range

Knauf has launched a new range of powdered joint fillers and finishes that give improved workability for contractors and provide a better finish for follow-on trades.

Joint Filler Premium and Joint Cement Premium provide bedding and finishing for joint tape respectively while the Fill and Finish Premium option can be used for both applications.

The Premium range was developed following extensive research with contractors, researching the characteristics that would be required from a perfect jointing range.

The result is an easy to use range with a finer finish, great coverage and setting time options.

The Fill and Finish product is available in two options with a choice of 30 or 60 minutes working time – ideal for smaller projects. Knauf Joint Cement Premium for finishing joints by hand gives a finish requiring minimal sanding. Site trials suggest that this is a significant advance on alternatives available in the market and is ideal for larger contracts.

Knauf Joint Filler is also proving popular for larger projects where the 90 minute working time should eliminate any waste caused by premature setting in the bucket.



TX[®] 110

**RAPID DRYING
INTERIOR FILLER**



**“QUALITY WHETHER
YOU WANT IT OR NOT”**



- ▶ **EXCEPTIONAL ADHERENCE**
- ▶ **EXCELLENT SHAPING QUALITIES**
- ▶ **NO NEED TO SPOT PRIME**
- ▶ **WILL NOT FLASH OR GRIN**
- ▶ **CAN BE PAINTED IN 3H**

Unit 58, Capital Business Centre, 22 Carlton Road, Surrey, CR2 0BS
☎ +44 (0) 208 916 2134 ✉ toupretuk@toupret.com



TOUPRET[®]
THE PROFESSIONALS PREFERRED FILLER

WWW.TOUPRET.CO.UK



Dulux ACADEMY



Give the competition a pasting

20% off
Wallpaper
Courses*

Discount code: **Wall20**

INTERNATIONAL
WALLPAPER
WEEK
1-7 OCT 2018

Our **Dulux Academy wallpaper courses** will give you the skills and confidence to master a wide range of wallpapering techniques, from **measuring and setting out, applying lining papers and finished wallpapers** right through to **digital murals, relief wall coverings and wide-width vinyls**, enabling you to offer the latest trends to your customers with stunning results. And, with a **20% discount*** available, there has never been a better time to book.

*Terms & Conditions: Enter discount code **Wall20** when booking online at www.duluxacademy.co.uk to receive a 20% discount across all of our wallpaper courses including wallpaper techniques, advanced wallpapering, wide-width vinyls, digital murals & feature walls and relief wall coverings. Offer is valid on bookings made before 31st October 2018 and cannot be used in conjunction with any other offers or discounts. No cash alternative.

www.duluxacademy.co.uk