

The Professional Painter & Decorator

AkzoNobel

Roll on to
**bigger and
better things**



Dulux Academy. The home of
painting and decorating excellence

Our team of leading industry experts deliver learning experiences centred around you, offering a range of courses at every stage of your decorating career. Our courses deliver increased knowledge and understanding, enabling you to meet your personal and professional ambitions.

We look forward to seeing you very soon.

To book a course please visit

duluxacademy.co.uk

Dulux
ACADEMY

THE LITTLE ONE-HAND SANDERS

with speed control and PES filter cartridge in set

DELTA SANDER

ODE 100-2 set

- 200 watt
- 8000-13000 rpm
- 16000-26000 opm
- Orbit 2 mm
- Only 1.2 kg
- Including sanding paper 1 x P 80 and 1 x P 120
- External dust extraction Ø 27 mm



SMALL SURFACES AND EDGES

PALM SANDER

OSE 80-2 set

- 8000-13000 rpm
- 16000-26000 opm
- 200 watt
- Orbit 2 mm
- Only 1.2 kg
- Including sanding paper 1 x P 80 and 1 x P 120
- External dust extraction Ø 27 mm



CORNERS AND EDGES

RANDOM-ORBIT SANDER

ORE 150-5 set

- 350 watt
- 5800-10000 rpm
- 11600-20000 opm
- Orbit 5 mm
- 2.1 kg
- Including sanding paper 1 x P 80 and 1 x P 120
- External dust extraction Ø 27 mm



ROUND SHAPES

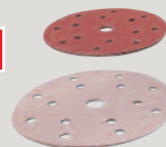

SAFETY VACUUM CLEANER

VCE 26 L MC

- 1250 watt
- 3600 lpm
- 21000 Pa
- Container Volume 25 l / Wet vacuuming 16 l
- 8.4 kg



For more information please contact

Stuart Colclough

P0 Box 192, Darlington DL1 9FN
Phone +44 (0) 1 325 741793
Fax +44 (0) 1 915 045133
Mobile +44 (0) 77 909 90682
uk.sales@flex-tools.com

FLEX

Das Original

The Professional Painter & Decorator

INCORPORATING THE PAINTING & DECORATING JOURNAL

News	2
Concrete Paint Finish	10
Our new specialist finishes expert Cait Whitson explains how to achieve this effect using paint.	
Dulux Academy Extends Spray Courses	12
With over 50 courses currently on offer, Dulux Academy reports that its spray application courses are currently amongst the most popular.	
Farrow & Ball – old and new	16
Although famous for its colours, F&B is as strong technically as it is traditional.	
Johnstone's Trade talks water-based in Facebook live panel event	20
Richard Mazurkiewicz of Johnstone's Trade, explains how the brand used Facebook Live to answer the industry's questions around water-based technology.	
The National Painting & Decorating Show	24
What's on, who's there and, importantly, your free ticket.	
Spray on protection	30
Protectapeel is a range of temporary protective coatings for protecting non-porous surfaces.	
Brewers brief	34
Decorating Solutions from Axus Décor	35
AkzoNobel £100m investment in the North East	36
AkzoNobel has opened what it describes as the world's most advanced and sustainable paint factory.	
Powering up	42
Powered access obviously saves time but this must be offset by cost. We look at what Facelift has to offer, together with hire prices.	
A moulding for marble	44
The second in the trompe l'oeil features by Robert Woodland.	
On test: sheet sanders	46
On test: Renault Master LM35	50
Marketplace	54
Wagner's new Control Pro	64
The new Airless paint sprayers from Wagner feature reduced pressure, minimised overspray and maximised control.	



**The National
Painting & Decorating Show
Nov 28th - Nov 29th 2017**

Editorial David Pescod
Advertising Richard Daynes

Published by
DPA Publishing Ltd
Stoney Lane Barn
Stoney Lane
Bovingdon
Herts HP3 0LY

Editorial: 01303 238002
Email: davidpescod@aol.com

Advertising & Subscriptions: 01442 832715

Production The Orange Design Group

Printed by Wyndeham, Roche
Subscription £18.00 p.a. (in the UK)

Subscribe to the

**The Professional
Painter &
Decorator**

**only
£18 per year
(including postage)**

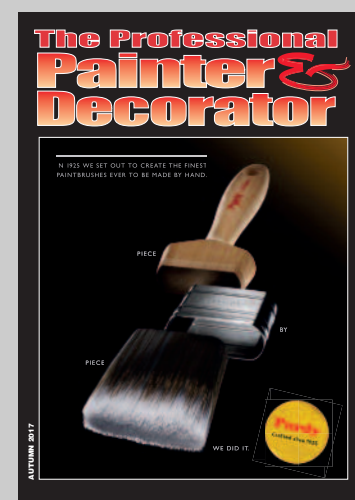

**It's the only way of ensuring
you receive your copy**

Published 4 times per year -
February, May, August & November

Make cheques payable to
DPA Publishing Ltd

Orders can only be accepted with payment

Send to:

DPA Publishing Ltd

Stoney Lane Barn, Stoney Lane,
Bovingdon, Hertfordshire HP3 0LY

SUBSCRIPTION

Name: _____

Company: _____

Address: _____

Postcode: _____

Email: _____



AkzoNobel's 2018 Colour of the Year

Heart Wood has been unveiled by AkzoNobel as the Colour of the Year for 2018, following continuous research into trends, insights and consumer behaviors.

A subtle and warm tone of pink, Heart Wood draws from the tactile qualities of natural wood and leather, conveying comfort and ease in response to consumers wanting to nestle down more and create a "welcome home".

Lucas launches college partnership

Lucas has appointed its first fully qualified training and apprenticeships manager and is partnering with London South East Colleges as part of its commitment to bring together college vocational courses with practical, on site training.

Barry Mason joins Lucas with over 30 years' experience as a painter and decorator. He is also a qualified assessor and instructor and is a former lecturer at Shrewsbury College. He is making a series of practical training videos with Lucas called "Brush up with Barry."

Lucas has now reached a major milestone by securing accreditation from City & Guilds to be able to assess candidates for their NVQ Level 2 qualifications. The partnership with London South East Colleges gives the opportunity to build a satellite training academy, the Lucas Centre of Excellence, developing full NVQ and City & Guilds diplomas with a mixture of classroom theory, E-learning or distance learning for young students, and practical site-based tuition, experience and formal assessment.

Lucas has discussed issues of training and the skills shortage in construction with Government and concluded the best way forward must involve companies in the training process, and convey the true site experience and demonstrate the full range of skills and disciplines required to be a successful operative today.

WIPD



selection of paints

Upmarket Corsavan

Vauxhall has expanded its popular Corsavan range with the addition of a new top-of-the-range Limited Edition NAV model. Available to order now, the new variant offers some of the latest technology and stylish exterior design features.

The new Corsavan Limited Edition NAV model features exterior graphics, as well as black wing mirrors, 16-inch Black Alloy Wheels and a Carbon Flash grille bar. The stylish new black accents have been designed to complement the Corsavan's full range of exterior colours (excluding Royal Blue and Metallic Black). The new model also marks the introduction of the Persian Blue exterior colour, which is offered exclusively on the Limited Edition NAV.

As well as a new look exterior, the new model trim will add Navi 4.0 IntelliLink connectivity to. The updated system has a seven-inch colour touchscreen for easy navigation, with features including RDS with Traffic Programme, Eco Routing, DAB digital radio, and sat nav with European coverage. The unit's smartphone integration is compatible with Apple CarPlay and Android Auto, and enables USB connection, Bluetooth connectivity and A2DP audio streaming.

Design first

Barrie Thompson is first winner of Dulux Academy's first ever Design & Decorate Challenge. Barrie will have his own winning wallpaper design put into production and have the opportunity to visit the Graham & Brown factory, where he will also learn about the brand's heritage, the manufacturing processes used over the years, wallpaper design and future trends.

The competition, which Dulux Academy launched in partnership with Graham and Brown in celebration of International Wallpaper Week (2nd – 8th October), was designed to support the craft and skill of wallpaper hanging. Aimed at experienced decorators with an eye for design and acute attention to detail in the installation process, appliers from across the industry were required to nominate themselves online. Finalists were then invited to submit their very own wallpaper designs to be judged by industry specialists on 2nd October, before being invited to attend the grand finale on 6th October, held at Dulux Academy, where their wallpaper hanging skills were put to the test. Finalists were awarded points both for their wallpaper design and their performance in the application challenge before the winner was selected.

DESSERT



Brewers
DECORATOR CENTRES



brewerspains

Over 150 branches, for your nearest call 01323 411080 or visit www.brewers.co.uk

Safety concerns over mixing tower components

Supplier of access towers, WernerCo, is highlighting the serious safety risks associated with mixing product components when building towers.

This follows concerns being raised in the industry over the practice of mixing components from different manufacturers when erecting towers. As a result WernerCo, which manufactures the brand BoSS, is urging people to be aware of not only the safety risks but also the dangers around building a non-compliant structure.

Towers should comply with specific standards, which give approval the overall tower structure rather than specific components. When combining components from different manufacturers, a new structure has been created that has not been tested to EN1004:2004 and, therefore, does not comply.

Uni redeco

Crown Trade Steracryl Mould Inhibiting Matt Paint, Crown Trade Clean Extreme Scrubbable Matt and Crown Trade Fastflow Quick Dry Gloss are all being applied as part of the refurbishment of 57 dormitories and associated kitchen areas at the University of East London's Docklands Campus.

"We've been working with Crown Paints now for four years and their products are being used because we have such a quick turnaround to get the rooms ready and we have to trust what we use."

Under the programme of works, Crown Trade Clean Extreme Scrubbable Matt is being applied to the kitchen and bedroom areas.

Ideal for spaces that receive a high level of traffic, Crown Trade Clean Extreme is 100 per cent more stain resistant than standard matt vinyl emulsion paint - and can be scrubbed up to 10,000 times meaning that product will extend the University of East London's maintenance cycle.

As well as Crown Trade Clean Extreme, other products selected for the project include Crown Trade Steracryl Mould Inhibiting Matt Paint for the bathroom ceilings, while Crown Trade Fastflow Quick Dry Gloss system is being used on all of the doors in the accommodation block.



MADE FOR BUSY AREAS



A HARD-WEARING MATT EMULSION WITH A WASHABLE FINISH. THE STAIN & MOISTURE RESISTANT FORMULA PROVIDES LONG LASTING PROTECTION, MAKING IT IDEAL FOR BUSY AREAS.



T: 0330 024 0313

W: WWW.MACPHERSONTRADE.CO.UK

Macpherson
TRADE PAINTS

IN 1925 WE SET OUT TO CREATE THE FINEST
PAINTBRUSHES EVER TO BE MADE BY HAND.



PIECE

BY

PIECE

WE DID IT.



purdy.co.uk

Happy landings with Bradite refreshed helipad

Air ambulance helicopters now have a distinctive new helipad at a Chelmsford hospital, thanks to a repainting job using Bradite products.

Bradite's CF22 Chlorinated Rubber paint was specified to recoat the previously painted concrete deck. Chelmsford-based Kestrel Maintenance

took on the job, beginning by high-pressure hosing the helipad surface to remove all loose and flaking paint and degreased with Bradite TD39 detergent to banish any remaining oil contamination.

Chlorinated rubber is quick drying and the helipad received two coats of CF22 and was ready to take light foot traffic after drying overnight with full curing taking effect in less than four days.



Brewers customer wins a year's supply of paint

Horsham customer Alan Clack Brewer's lucky Win a Year's Worth of Paint competition winner. Having shopped at Brewers Horsham since 1980, self-employed painter and decorator and owner of Simply Colour, Alan was surprised to have been selected; "I'm bemused but very chuffed, how could I not be!"

Alan entered the competition whilst visiting the Horsham branch back in April after branch staff member Dave advised him to enter.

Working mostly in the local Horsham area, Alan's projects have ranged from pubs and churches, to hospital units and recording studios. Whilst working in recording studios, Alan has been known to work and socialise alongside some well-known artists, most notably; Paul Weller from The Jam, Peter Green from Fleetwood Mac and Topper Headon from The Clash.



Woodcare
Experts Since
1912

Professional Hard Wax Oil

- Natural oil and wax based formula
- Available in 6 decorative colour finishes
- 30m² per litre



6
COLOURS

Hard Wax Oil

- Provides a waterproof and stain resistant finish
- Maintains the natural look of the wood
- Waterbased formula



**QUICK
DRYING
FORMULA**

For more information on our products and our stockists
please get in touch: www.liberon.co.uk | 01797 367555

V33
GROUP
A V33 Group Company



As good as new

With an ultimate stain resistance and class 1 scrub rating, Crown Trade Clean Extreme Scrubbable Matt lets customers scrub away stains without damaging the surface or your fine work.

Crown Trade, Proud Sponsors of



Tel: 0330 040297 Email: info@crowntrade.co.uk Visit: www.crowntrade.co.uk
© Crown Paints Ltd, Crown House, Hollins Road, Bolton, Lancashire, BB10 0BB

It's not just paint.
It's personal.®

Top apprentice Decorators prepare battle

The competition to find the UK's Crown Trade Apprentice Decorator of the Year is heating up as the eight finalists are revealed.

Now, the eight will go on to compete at the Skills Show, at Birmingham's NEC from November 16-18, with a £1,000 first prize at stake.

The finalists are: Aiden Dearie of City Building Glasgow, Callum Bonner of Forth Valley College of Further and Higher Education, Declan Collins of Dundee and Angus College, Oliver Takhar of Bath College, Patrick Dinham of Newcastle College, Philip Orme of City College Plymouth, Lewys Rawlings of Coleg Cambria and Thomas Pawlowski of West Suffolk College.

The contest, in association with the Construction Industry Training Board (CITB), is the longest running showcase of talent for up-and-coming painters and decorators and this year celebrates its 38th anniversary.

The Apprentice Decorator of the Year competition is a key part of Crown Trade's ongoing programme to help address a skills gap which has emerged within the industry.

Figures released by the Construction Industry Training Board revealed that more than 13,000 painters and decorators will be needed before 2018 to meet growing demand.

Toolstation Research Reveals Trade Health Issues

New research conducted by Toolstation reveals that almost three-quarters of the trade have suffered from work related injuries, aches, pains and strains – with 79% of those surveyed believing it has affected their ability to carry out their work; as well as having a negative impact on their personal life.

The survey of Toolstation customers was carried out in June 2017, and highlights the challenges faced by the trade when injuries occur – particularly the financial and emotional impact. 74% of respondents were sole traders, with over half of those surveyed confirming they'd needed to take time off work due to their injuries; resulting in loss of income and causing high levels of stress, as summarised by one respondent who said:

"Being self-employed, if you get injuries at work it can have an extremely adverse effect on your mental wellbeing, causing stress. If you are unable to work then you are unable to earn."

As a result of the pressure to work and earn, many in the trade just 'get on with it' despite their pain and suffering, as highlighted in comments including:

"I find it very hard to recover from my continuous pains and strains.

The facts are that these injuries require resting the affected areas, but the reality is that my aches and pains are overshadowed by the impact of financial loss due to not working."



LIBERON

Woodcare Experts Since 1912

Premium protection for your Precious Wooden Surfaces

Liberon's range of high-quality interior oils will enhance and offer long-lasting protection for your precious wooden floors and furniture

Quick Drying TUNG OIL | PURE TUNG OIL | SUPERIOR DANISH OIL | TEAK OIL

For more information on our products and our stockists please get in touch: www.liberon.co.uk | 01797 367555

V33
GROUP
A V33 Group Company



PAINT TO BE PROUD OF



MOVE WITH THE TIMES
TO SAVE TIME.



Concrete Paint Finish

Our new specialist finishes expert Cait Whitson is decorative painter working throughout UK. You can see her work and connect with her on social media; Twitter and Instagram - @paintycait or Facebook - www.facebook.com/carteblanchedecorativepainters/

Concrete finishes are some of the hottest finishes of 2017 – they are good for both commercial and domestic environments and are fashionably combined with metal, wood and other natural materials for a cool industrial look. Very often this look is carried out in a plaster like Marmorino or Intonachino but I also like achieving the look in paint.

First the wall needs to be sealed - absorbancy will mean it dries too quickly. If it is good clean emulsion then you need only put a thin layer of something like Zinsser Gardz or Polyvine Decorators Varnish. The background colour will be almost obliterated, so unless it is a really jarring colour you can work over what you have. If you need to paint out the surface a coat of slightly thinned acrylic eggshell is perfect.

For the finish I have used two colours of eggshell - a very dark grey and a light grey and mixed these together to get a third mid grey. I use Benjamin Moore Aura Eggshell or General Finishes Milk Paint because both these dry relatively quickly to a low sheen. The colours I used here were General Finishes Queenstown Grey and Seagull Grey but Benjamin Moore's Westcott navy and Boothbay Grey



would be similar.

I use old tools for this because it is a messy process and doesn't require perfect tools – an old polished plaster small trowel, a couple of old spatulas and some worn sponges are perfect. If you don't have a trowel you can cut a slice from the side of a 10l paint bucket and sand the edge to create a spreading tool.

Stage 1 First use the spatula to put the paint onto the trowel and spread it leaving some areas without paint and others thicker paint; as you work across the wall double back and use a sponge to wash over the part drying surface and this will lift the thicker areas leaving interest and soften the look. These lifted areas will fill with the next stage.

Stage 2 Once dry take the mid tone and apply a trowelled layer like the first. Double back but this time with the palest grey and wet on wet trowel the lighter colour into the mid tone. Some will mix, some will stay on the mid tone. Work across the wall in this fashion.

Stage 3 Before this layer dries double back once more and wash a damp sponge over it again.

This will lift some of these lighter colours and soften the look. If it is a large area having 2 pairs of hands is a lot easier and avoids it drying up too much to get that final washed effect. This is how I achieved the finished effect in Image 4.

Because it is created in eggshell, no varnish is required.

There are extra things you can do – while wet you can dribble water through it giving it a weathered look and also maybe sponge some of the colour off revealing the dark base, you could also spatter some of the dark into the surface. Once dry you could use an acrylic scumble to create yellow aged areas or just increase the depth, although this will need a final varnish to protect. All depends on the budget and the look your customer wants.

See technique application on YouTube
<https://youtu.be/LblUpZqoJYo>

Stage 2



Stage 3





Dulux Academy extends spray courses

Since opening in March 2016, Dulux Academy has been updating its courses in line with increased demand.

With over 50 courses currently on offer, Dulux Academy reports that its spray application courses are currently amongst the most popular.

Tony Pearson-Young, Skills Development Consultant at Dulux Academy, said: "On the whole, the industry tends to view spray application as only appropriate for commercial work, but once individuals understand the correct processes of spraying they see how adaptable this method of application is and can explore opportunities for using it in domestic environments.

"Many that join our courses still view spray application as a new method and have little knowledge of the processes

involved and how it might benefit their business. Others have already invested in spray equipment and would like more training to ensure that they're using everything correctly. Whatever their reasons for joining courses, the common theme is that delegates leave with increased confidence and a better understanding of how they can use the method in new ways, all of which ultimately benefits their customers."

A recent attendee on the Introduction to Spray course, Christian Bone, who founded Paintworks 11 years ago, commented that:

The Wagner logo is located in the top left corner. It features a black triangle above the word "WAGNER" in a bold, black, sans-serif font. The entire logo is set against a bright yellow rectangular background.

WAGNER

WE JOIN FORCES.

HeavyCoat 750:
Next Generation Airless

HydraStroke
TECHNOLOGY™



wagner-group.com

"After being on the brush and roller for that long, day in and day out, I was starting to lose my drive a bit and knew I needed to learn a new skill. Not only a skill I would benefit from but a new skill my customers would benefit from too."

The course introduced Christian to a variety of both airless and HVLP spray units, all of which were provided by Graco. During the day Christian was able to develop his masking and spray application techniques using this premium equipment.

"I came away with the confidence to spray after just one course. I've completed four jobs so far using spray application since I did the course. So, taking the time out to attend really did pay off in the end" Chris concluded.

While all courses offer a mix of theory and practical application, many applicators attend to gain knowledge on equipment they may require ahead of a purchase. Conscious of this, Dulux Academy puts a huge effort into maintaining relationships with supplier partners to ensure that all equipment used on courses is amongst the best on the market. The most recent additions to the equipment portfolio are the Tri-tech T4 Airless and the Graco 395 Air Assisted Airless.

"As we continue to develop the courses to meet the needs and requests of our customers we're keeping ourselves up-to-date with the latest equipment and materials available in the industry. Zipwall, for example, provides a great system to enclose a working area protecting from over sprays which we can showcase to our course delegates to assist them in their understanding of what's available in the market to assist them as professional decorators," said Tony Pearson Young. Dulux Academy offers a range of spray



courses, aimed at decorators of all levels. They are all one-day courses and are delivered across the UK at selected locations so there is minimal disruption to the working week.

The Introduction to Spray course covers all of the essential basics of Airless and HVLP including how to set-up, maintain, clean and store equipment, tips on the practical application required to achieve a perfect finish, how to recognise faults and take action to correct them, and of course the safe working practices necessary for using

this type of equipment.

Following the success of the Introduction to Spray course, two new advanced courses have recently been added to the Dulux Academy offering. The Advanced HVLP focuses on using the equipment on more specialist surfaces including stair spindles and ornamental cornices, and the Advanced Airless course focuses on the variety of tips and accessories available to assist in a range of working environments, such as power rollers and extension lances. Both of these courses go into more technical detail which leaves delegates with the confidence to breakdown and rebuild their equipment as required.

Tony Pearson-Young, concludes that: "All of the courses are delivered by our in-house industry experts who have over a hundred years of decorating experience between them. Courses are held in our purpose-built training environments with group sizes of a maximum of 8 people. This ensures that all attendees get the best learning experiences possible and get everything they need out of their course."

Christian, who appreciated the industry knowledge, the experience the Dulux Academy has and the style in which the course was delivered, said: "In my eyes this is how a course should be -

learning with a bit of banter in the mix. We are decorators at the end of the day!"

Should you have specific needs, Dulux Academy has the ability to provide bespoke courses for groups of four or more. All course costs include use of equipment, resources and full hospitality.

To enrol on a Dulux Academy course please visit www.duluxacademy.co.uk

RUST-OLEUM®

— INDUSTRIAL —



Wood



Metal*



Masonry



Glass

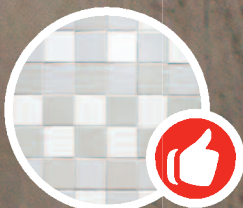

Tiles



Galvanised



PVC



Concrete



COMBICOLOR® MULTI-SURFACE

All-in-one-paint (primer + finish)

- Direct to surface
- Paint & primer in one
- Quick drying
- Interior and exterior

KNOW-HOW TO PROTECT™

WWW.RUST-OLEUM.EU

Farrow & Ball

– old and new

Although famous for its colours, F&B is as strong technically as it is traditional.

Farrow & Ball is undoubtedly the best known name in paint and wallpaper in the trade, retail, and specification markets and with homeowners – that is, after the big three paint manufacturers. It's not a niche producer – it has 132 paint colours in a range of 11 exterior and interior finishes from flat matt to high gloss. But it does have a niche – colour. The Farrow & Ball franchise is its colours and the names it gives them – Charlotte's Locks, India Yellow or Churlish Green are some of the least outlandish but all have a genuine meaning and a link with the brand.

We know this because of the familiar tale of the customer, or indeed the decorator, taking an F&B colour card to a merchant or one of the sheds and saying match this. Farrow & Ball is a premium product and a little over £70 for five litres, more than twice what you'd pay for a standard brand. It's a compliment to F&B's colours that, using a spectrophotometer, the colour can be approximated but that's it. It cannot be matched, and the actual finish could be very different. And this is dictated by the manufacturing process.

All Farrow & Ball paint is made on one site in Dorset. All the colours are pigmented from two bases – one for lighter colours and one for



Manually applied **interior and exterior fillers**

PRESTONETT®

PROFESSIONAL TRADE QUALITY



- Does not shrink or crack
- No thickness limitation
- No Flashing
- Easy to sand
- White

**PRESTONETT Interior Filler...
GETS THE JOB DONE!!**



For more information
www.beissier.eu



Beissier

contact@beissier.eu · **Tel : 020 7092 6696**

Fax : 020 7092 6698 - 4th Floor - 300 High Holborn - London WC1 7JH

darker – and these bases are from mixing the water with titanium dioxide, resins and other ingredients. These formulations give the body and build to the paint. The pigments are not made on site, but are produced solely for F&B alone and there are generally three used to make a colour, with perhaps a fourth in a lesser quantity. To create a colour using so few pigments mean they have to be used in a high ratio to the overall volume of the paint.

After each batch is made, a sample is drawn off from the vat and taken to the lab. It is then painted mechanically on to a card for



consistency and allowed to dry. Then it is matched against a standard for the colour using a spectrophotometer, and will only proceed to market if it is within the tolerance level of 0.45DEcmc. To put this into perspective, F&B's own research suggests that some tinting machines work to a tolerance level exceeding 1%. If that 0.45DEcmc is not met, a computer programme will generate the correction needed in terms of ingredients, the paint will be corrected and the lab process will start again.

The formulations for the paint do evolve, reflecting what the market wants, without ever compromising depth of colour or the finish. Gareth Hayfield, head of research and technical development, told us that there is now more titanium dioxide in the lighter base which helps opacity and coverage and that pigment levels have risen by up to 20%.

"We look at what customers want and we take feedback from all the markets we supply."

F&B has a strong customer base in most European countries and further afield. And this is not just for paint but also its wallpapers. These are manufactured on the same site.

What makes F&B wallpapers so different is that they are painted, not printed. This is why they are expensive but stunning in design and colour and shipped out with detailed hanging instructions. The paint

used is more liquid than an emulsion but other than that the same.

The process begins by painting a base colour on to a relatively high weight paper. And there are a lot of base colours, some for a number of papers, others for just one. When a paper is ordered, the pattern which is on a roller or block (depending on the length of the repeat) goes on to the appropriate machine, the paint applied and the edges trimmed. These machines have highly skilled operators who need to be able to see, by eye, when the paper is right, and also need to be able to set up the edge trimmers so the drops can be matched.

Farrow & Ball has been in business for 70 years and when you look around the plant, you can see that certain processes probably haven't changed much, but the products have. Since 2010, all the paints have been waterborne, obviously reacting to EU directives but nevertheless a big step in product development and one which illustrates a strong technical drive within the company.



Wayne Armstrong, the lead decorator at Farrow & Ball, joined the research and technical team in 2013 after more than 30 years within the paint industry. Commenting on their paints, Wayne said: "I'm able to say that within each tin of Farrow & Ball paint you'll find the highest levels of titanium dioxide and pigments giving you excellent coverage and depth of colour".

Farrow & Ball were pioneers of water based paints, taking the decision to switch its entire range from oil based as early as 2010, after four years of development and extensive in-house testing.

Wayne continues: "Like a lot of traditional decorators, I was nurtured on solvent based paint, however for the past nine years I have been solvent free and have never regretted the change. My biggest tip is to use them and see what they can do. I don't think everyone realises the benefits such as the low odour, less yellowing, quicker drying time and how easy it is to clean brushes afterwards."

There are some differences for using water based paints and Wayne recommends dampening the brush first and then spin out. He also suggests applying a thicker coating to aid application, and as you have less working time with waterborne coatings, laying it on and off as quickly as possible to achieve the best results. He also recommends using a good quality synthetic brush or medium pile woven sleeve roller, always checking the product advice sheets (especially regarding primers and undercoats) and applying two top coats to build the layers of pigment.

For more information on Farrow & Ball paints, wallpapers, and handy application tips, visit farrow-ball.com.

OI MOULD YOU'RE ON OUR PATCH



Mould and mildew have a nasty habit of coming back. And we can't have that. Our **Perma-White** paint makes sure **what's gone, stays gone**.

Find your nearest supplier at zinsseruk.com

@zinsseruk #whatsyourproblem



Johnstone's Trade talks water-based in Facebook live panel event

The market for water-based solutions has expanded in recent years, although many professional painters and decorators still have reservations about performance. Here, Richard Mazurkiewicz, Marketing Manager at Johnstone's Trade, explains how the brand used Facebook Live to answer the industry's questions around water-based technology at a Johnstone's Trade All Access Day.



For many years, water-based technology has been a hot topic of conversation among professional painters and decorators. In fact, since changes to VOC legislation were announced in 2010, the industry has been putting water-based solutions through their paces and comparing the qualities of the paint to those of solvent-based.

At Johnstone's Trade, we've worked with professionals in the industry to gather feedback and input around our water-based technology, but recognise that there are still many experienced painters and decorators who have questions that need answering.

That's why, during an All Access Day, we hosted an industry first Facebook Live event, giving professionals unrestricted access to our technical experts.

We believe that customer feedback is fundamental to the success of the painting and decorating industry, and it's vital that

professionals are being listened to. Ahead of our first ever Facebook Live panel event, we reached out to our social media community and encouraged them to submit their most pressing questions regarding water-based technology.

These questions – alongside any received live during the event – were put to an expert panel from our technical team.

There was a range of interesting questions submitted before and during the live broadcast. However, there were three key themes that were apparent in the questions being asked: the development of water-based technology, the technical differences between water-based and solvent-based products, and brush maintenance.

When it comes to water-based technology, there are a number of benefits. The products are low odour, quick drying, easy to use and have a good sheen level. This means projects can be completed quickly, and in an industry where time is money, that's a key



benefit.

Johnstone's Trade Aqua products are a hybrid technology, meaning they take all the benefits of solvent-based products, alongside the cleaner, better for the environment elements of water-based systems. On a chemical level, this is because the products incorporate the use of traditional alkyd resin predominantly used in solvent-based products, but in a water-based system.

Professionals often wonder whether water-based products are as durable as oil-based equivalents. The panel explained that water-based technology has evolved dramatically from when it was first launched. Today's water-based paints are as durable as solvent-based products, but it goes back to the old adage that the paints are only as good as the substrate they're going on to. If the



Download the Professional Decorator App:



GET IT ON
Google Play



Download on the
App Store



tesa[®] PROFESSIONAL

FOR RESULTS YOU BUILD YOUR REPUTATION ON.

RAZOR SHARP PAINT EDGES <
NO PAINT BLEED <
SAVE TIME – NO CUTTING IN <



tesaUK

@tesaUK_tape

tesa.co.uk/craftsmen

preparation is right, there shouldn't be any durability issues.

With Johnstone's Trade's Aqua system, the way products are applied also plays a big part in the finished results. Aqua products behave totally differently to solvent-based paints and slightly different application techniques can be key to getting the best. To get the best finish, the panel recommended applying Aqua Gloss needs on top of the Aqua Undercoat, providing a far better film build.

There are also a number of other considerations that can help to ensure success when using the products. How to clean brushes, for example.

Our expert team explained that all brushes used for applying Aqua products should be synthetic, designed for water-based products. If a brush is left inactive for any

amount of time, it's really important to ensure it is left standing in paint up to the ferrule and that the brush is cleaned against the edge of the can before using again.

Our experts also advised using clean spirit first to soften brushes, washing them with soap or washing up liquid, then rinse them out with cold water. This helps to keep bristles soft.

In addition to attending the Facebook Live and gaining insight from our technical team, members of the Talk Group for Painters and Decorators who attended the All Access Day got behind-the-scenes access to the



Johnstone's Trade head offices in Birstall, Yorkshire.

The aim of the day was to give professionals exclusive insight into our range of water-based solutions, and allow them to share their feedback on the products.

Attendees took part in a range of different activities,

including the application of Aqua solutions in a number of common scenarios and a Graco spraying machine taster session. They also took part in an exclusive blind testing session with water-based technologies, some of which haven't been launched to the market yet. Members of the forum were also given a look into the history of the Johnstone's Trade and PPG brands.

The Facebook Live video is available to view now on the Johnstone's Trade Facebook page:

www.facebook.com/johnstonestradepaints/videos/1556724151070642/.

The Original Poultice Paint Removal System **PEELAWAY**®

THE SAFER, MORE EFFICIENT WAY TO REMOVE ALMOST ANY TYPE OF PAINT OR VARNISH IN ONE EASY APPLICATION FROM A VARIETY OF SUBSTRATES.



- ARCHITECTURALLY SPECIFIED ✓
- METHYLENE CHLORIDE FREE ✓
- ENVIRONMENTALLY SAFER FORMULATION ✓

PEELAWAY® 1

The Poultice Paint Removal System 1

- **EASILY REMOVES UP TO 32 COATS** of Paints & Varnishes containing Oil, Lead Polyurethane or water.
- Suitable for Wood, Brick, Stone, Concrete, Marble, Decorative Plaster, Cornices and Plaster walls.
- Also removes painted wall paper.
- Water-based Alkaline formulation.

PEELAWAY® 7

The Poultice Paint Removal System 7

- **EASILY REMOVES UP TO 20 COATS** of Architectural, Domestic, Industrial and Marine Coatings.
- No dangerous fumes or toxic particles.
- New modern alternative for PEELAWAY 1.
- Does not require neutralising on application.



A **FREE Peelaway DVD** is available on request.

Barrettine
TRUSTED BY THE PROFESSIONALS

St. Ivel Way, Warmley, Bristol BS30 8TY.

T: 0117 960 0060 F: 0117 935 2437 E: sales@barrettine.co.uk

www.barrettine.co.uk



The time to express yourself is here.

Finally an innovative new decorating range that allows you, the professional, to achieve the full expression of your skill and creativity. Featuring Max Stroke™ technology, our advanced synthetic filament mix gives a perfectly smooth,* consistent and fast finish.

Stay ahead of the curve at hamiltonexpression.com



HAMILTON®

Featuring
Max Stroke™
Technology
for consistent
smoothness

*Independently tested for smoothness of finish using topography analysis at Innventia Sweden.

**YOUR
ENTRY
TICKET**

"UNMISSABLE!"



"THIS YEAR'S HOT TICKET"



"BRILLIANT CAST!"



THE NATIONAL
**PAINTING AND
DECORATING
SHOW**

**SHOWING 28/29 November 2017
RICOH ARENA, COVENTRY**

This year's National Painting and Decorating Show is a must-see! The biggest and best yet, it's your opportunity to see the latest products, proven best sellers, preparation tips and finishing techniques that will be making the news in 2018 and beyond.

STAYING AHEAD OF THE GAME

Professional decorators are always on the lookout for the latest colours, materials and textures, and the best tools to get every job done quickly and profitably. And this is the best place to find them!

FREE ENTRY TO SHOW. REGISTER TODAY!

A GREAT DAY OUT

An action-packed two days,
buzzing with:

- ▼ New product launches
- ▼ Practical demonstrations
- ▼ Fantastic show-only deals
- ▼ Free samples
- ▼ Hands-on trials
- ▼ Competitions, raffles and prizes
- ▼ Sporting challenges and celebrity appearances

You could be one of the first 1000 visitors each day to grab a gift-packed DecoBag on arrival!



BIG 'SHOW-ONLY' DISCOUNTS

The major manufacturers use the show to bring new products to market, while stockists tempt visitors with big discounts, and suppliers pack their stands with extensive selections of tools and workday essentials.

TAKE A BREAK

Coffee Zone sponsors GRAFT will be delivering an exciting new package. When you're refreshed with a hot cup of coffee go to stand 45 for the details



FIRST STOP AXIS

With a massive range of decorating tools and some great show-only deals, Axis Décor is a must-visit on stand 32, right opposite the registration area.





RAPID, EASY ACCESS TO THE SHOW
Coventry's Ricoh Arena, with its on-site hotel and choice of restaurants and bars, is easy to access by road, rail and air. It's just a two-hour drive from 75% of the country, with plenty of on-site parking, while Birmingham Airport is just a short drive away. Plus a brand new train station now services the venue!

SEE THE MASTERS AT WORK!



Brush and roller techniques, abrasives innovations, new decorative effects, spray demonstrations, timber repair – these are just some of the presentations by experts taking place every 30 minutes in two 'open-area' MasterClass theatres situated right in the centre of the exhibition. Check out the daily programme in your FREE show guide.



ABOVE AND BEYOND
With 70 years in the access equipment sector you can always be sure to see something special for decorators on the Lyte Ladders stand (16).

A PRIZE EVERY TIME!

As you walk around the show, watch out for the Fabulous Lucky Dip. Every visitor to dip their hand into the bucket is a winner, so have a go and you will take away some great gifts and useful promotional items.

COMPLETELY DIFFERENT...
Ciret will be showcasing a brush with a difference. Seeing is believing on stand 95.

GET SHIRTY
Stop off at the Bradite stand to pick up a sample of its Fastrac fast drying, rust-inhibiting coating and a FREE tee shirt (stand 91).

- ▼ Visit stand 6A and demo 3M's tapes, abrasives, safety equipment and damage-free hanging solutions
- ▼ Win £250 of Corona brushes on stand 33
- ▼ It's top secret for now – but Festool will be unveiling some brand new tools on stand 86.
- ▼ Ever thought of using a ladder on solid ice? That's what LadderM8trix will be doing to show how good their anti-slip products are. Stand 62A.
- ▼ Make a dash for the National Abrasives stand for free samples and great prize draws. Stand 115
- ▼ Looking for eco-friendly wood finishes? Osmo has the answer on stand 72.
- ▼ "Dry paint on a roll" – Watch this amazing demonstration on stand 76.

PRE-REGISTER NOW – IT'S EASY!



www.paintshow.co.uk

GYPROC GALORE

Visit the Gyproc stand (102) for a chance to win **£250** worth of products each day – what a draw!



STARRING . . .



3M UK

AJ Systems

Aristospray

Architextural

Artex

Axus Décor

Barrettine Products

Bedec

Big Wipes

Bradite

Chameledec

Bristol UK

Chemfix

Ciret

Coleman Bros

Coo-Var

Crown Decorating Centres

Crown Paints

D&A Sales

Dexters Workwear

Dripless Inc

Dulux Decorator Centres

Dulux Trade

Dunlop

Dupre Minerals

Eco Ezee

Farrow and Ball

Fat Hog

Festool

Flair Paints

Flex Tools

Graco

Graft

Gray Campling

Green Granite Tech Inc

Hamilton

Hayden Temblett

Henkel

Indasa Abrasives

Isomat

Jakob Haerdi

Jobman Workwear

Johnstone's Decorating Centres

Johnstone's Paints

Johnstone's 'Young Painter of the Year'

Kolorbond

LadderM8rix

Leyland Paints

Liberon

Little Greene Paint Co.

Lyte Ladders and Towers

Magpaint

Mirka (UK)

Motipdupli (Plastikote)

My Paintbrush

National Abrasives

Nitromors

Olfa Tools

Osmo UK

Packexe

Painting and Decorating Association

Painting and Decorating News

Painting Craft Teachers' Association

Paintshack

PaintTech Training Academy

Pioneer Brush

Polyseam

PPG Arch. Coatings

Prof. Painter & Decorator Magazine

Purdy

Rainbow Chalk Markers

Repair Care International

Rodo

Rollroy UK

Rupes

Rustins

Rust-Oleum

Saint-Gobain Adfors

Shaw Paints

Sherwin Williams

Shield Quality at Work

Shurtape

Silva Timber

Solvite

Staalmeester Brushes

Storteskens

Teknos

Tembe DIY Products

Tesa

Tetramass

Tikkurila UK

Tor Coatings

TradePoint B&Q

Treatex

Trimaco

Truestar Tools & Decorazione

Unibond

Uniform Clothing Solutions

Valspar

Vista Digital

Wagner Spraytech

Werner Co

Wetherby Group

Zipwall



The National Painting and Decorating Show 2017
Ericsson Halls, Ricoh Arena, Phoenix Way, Coventry CV6 6GE.
Tuesday 28th – Wednesday 29th November. 9.30am – 4pm



pdshow1



@pdshow1

TWO WAYS TO REGISTER

Hand in this completed ticket when you arrive **OR**
beat the queues and pre-register at www.paintshow.co.uk

PLEASE TICK THE BOX WHICH DESCRIBES YOUR COMPANY OR ORGANISATION'S MAIN ACTIVITY
(Tick ONE box ONLY)

- AA ☐ PAINTING/DECORATING CONTRACTOR
- AB ☐ ARCHITECT
- AC ☐ BUILDING CONTRACTOR
- AD ☐ DEVELOPER
- AE ☐ DISTRIBUTOR/STOCKIST
- AF ☐ INTERIOR DESIGN
- AG ☐ HOUSING ASSOCIATION
- AH ☐ LOCAL AUTHORITY
- AI ☐ PUBLIC UTILITY
- AJ ☐ COLLEGE/TRAINING ESTABLISHMENT
- AK ☐ OTHER (please state)

Have you visited the Painting and Decorating Show previously? YE YES ☐ NO ☐

Number of employees in organisation:

CA ☐ 1 – 5 CB ☐ 6 – 20 CC ☐ Over 20

Data Protection Act: Please tick if you do not wish to receive mailings from other companies ☐

MR MRS MISS MS

FIRST NAME:

SURNAME:

COMPANY:

ADDRESS:

TOWN/CITY:

COUNTY:

POSTCODE:

COUNTRY:

TEL:

MOBILE:

E-MAIL:

This ticket provides **FREE ENTRY** to the show for one person and is valid for both days. Just complete the coupon above and hand it in when you arrive.

To save queueing you can pre-register at www.paintshow.co.uk

If you would like more **FREE** tickets, call 020 8645 2433 or email info@paintshow.co.uk

Student Parties are welcome, but please note that party size is limited to six students accompanied by one tutor. Tutors only must pre-register at www.paintshow.co.uk or contact the organisers on 020 8645 2433

INTRODUCING THE NEW

"Fill and Sand Solutions"

Mini Fill™

HOLE AND CRACK FILLER

READY MIXED • READY TO USE • EASY TO APPLY, SAND AND FINISH

FILLS HOLES & CRACKS IN PLASTER AND DRYWALL

- Patented Built-in Spreader
- Ready Mixed, Ready to Use
- Easy to Apply, Easy to Sand
- Can be Sealed & Painted
- Can be Drilled & Plugged
- Clean up with Water
- Resealable with Airtight Stopper
- Drying times :
 - Up to 30 mins for hairline cracks & blemishes
 - 1 - 2 hours depending on depth for normal use
 - Up to 12 hours for deep fill
- Available from October 2017
- Download leaflets from our website



Actual Size (~23cm) • 80ml • Patented Tool & System

GYPHUM-BASED DRYWALL JOINT COMPOUND • DRIES HARD LIKE PLASTER



REMOVE STRIP

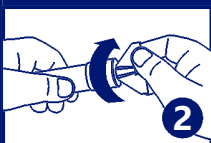

SCREW IN CAP TO PUNCTURE TUBE

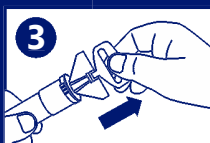

PULL OUT STOPPER



SQUEEZE AND SPREAD



TWIST AND FOLD UP TUBE AS YOU WORK



CLEAN WITH WATER AND USE STOPPER TO RESEAL

FARROW & BALL

CRAFTSMEN IN PAINT AND PAPER

SURFACES, SUBSTRATES AND GETTING THE RIGHT FINISH

Even when your client has decided on a colour scheme, the question of paint finish is an area often left for the painter to advise on. Our comprehensive range of paint finishes has been specifically formulated to allow you to deliver the distinctive Farrow & Ball look easily, no matter what surface you're dealing with.

INTERIOR FINISHES

Estate® Emulsion

Interior walls & ceilings

Our signature chalky matt finish suited for use in less busy rooms like lounges and studies. 2% sheen.

Modern Emulsion

Bathrooms, kitchens & beyond

Washable, wipeable, scuff, stain and mould resistant, this matt finish paint has been developed for use in bathrooms, kitchens and other high traffic areas. 7% sheen.

Estate® Eggshell

Interior wood & metalwork

A robust, hardwearing smooth, silk finish for interior wood and metalwork. 20% sheen.

Modern Eggshell

Interior wood, metal & concrete

Incredibly hardwearing mid sheen finish developed for high traffic surfaces like floors, staircases, skirting, architrave, and even kitchen cupboards. 40% sheen.

Full Gloss

Interior & exterior wood & metalwork

A high gloss finish that offers extreme durability on surfaces throughout interior and exterior wood and metalwork. 95% sheen.

EXTERIOR FINISHES

Exterior Masonry

Exterior walls & accessories

An extremely tough, high performance flat matt finish for external masonry surfaces, including brickwork and render. 2% sheen.

Exterior Eggshell

Exterior wood & metalwork

A flexible, breathable and hard wearing silk sheen finish developed for exterior wood and metalwork such as window frames, cladding and garden furniture. 20% sheen.

SPECIALIST FINISHES

Limewash

A highly breathable flat matt finish specifically formulated for lime rendered walls in traditional and historic properties, both internally and externally. 2% sheen.

Casein Distemper

A traditional distemper that allows interior plaster walls and ceilings to breathe, this finish can be used on solid walls that have no cavity. 2% sheen.

Soft Distemper

A flat powdery finish best suited to fine plasterwork and delicate surfaces, as it can be easily removed and helps maintain intricate details. 2% sheen.

Dead Flat

Interior walls ceilings, wood & metal

Super flat matt finish best suited for low traffic areas. Great for making a bold design statement and hiding uneven plasterwork in the home. 2% sheen.

For your free colour fan,
visit farrow-ball.com/thedecorator



Working with professional painters since 1946

WWW.FARROW-BALL.COM

FARROW&BALL

CRAFTSMEN IN PAINT AND PAPER

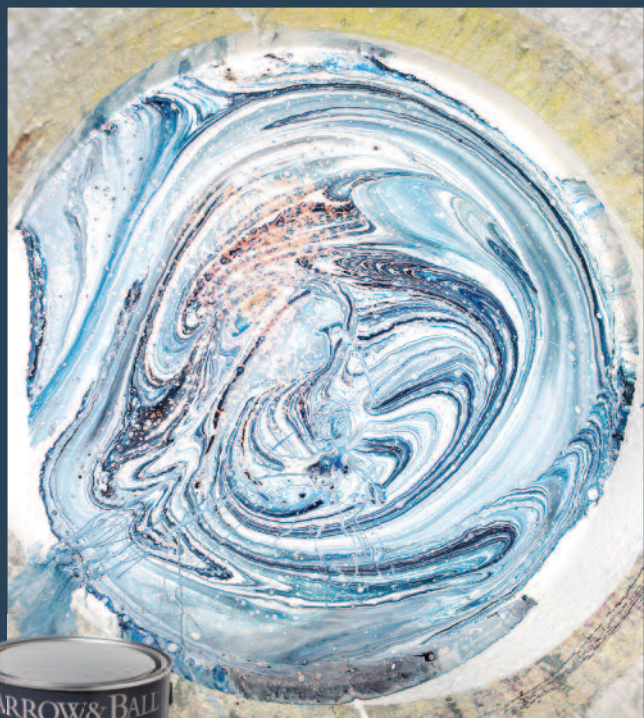

FOR YOUR FREE COLOUR FAN, VISIT
[FARROW-BALL.COM/THEDECORATOR](https://www.farrow-ball.com/the-decorator)

Terms and conditions apply. Please see web link for details.

Spray on protection

Protectapeel is a range of temporary protective coatings for protecting non-porous surfaces.

Protectapeel comprises a range of products that are applied as a liquid with either brush or spray equipment and when dry, forms a skin-tight bond to the substrate. When you've finished the job you are doing, simply peel off the Protectapeel coating to reveal the undamaged surface underneath. Once done, simply roll the film into a ball and easily dispose or recycle.

It's a quickly applied form of masking that you can use to protect against scratches, paint overspray dirt or dust. Protection lasts up to 12 months, and with products suitable for both

interior and exterior use.

One of the stand out products you might want check out is Protectapeel Glasstrip Original which is formulated to speed up masking the glass surfaces to protect from over-spray or painting

Other Products in the range include: Anti-rust – protects metal surfaces from abrasion and rust damage and Multisurface which protects plastic, marble, concrete, flooring, worksurfaces, laminate, tiles and more.

sales@holmanpaints.co.uk



NEXT TIME PREPARE FIRST & LEAVE HENRY IN THE VAN!



BIGGER

BETTER

PERFORMANCE



AS HEARD ON

talkSPORT 

LEARN
MORE



www.hippoproducts.co.uk

THE ULTIMATE VIVARO.

The Vivaro Doublecab comfortably seats up to six and still delivers the right amount of loadspace and payload. The absolute best of both worlds. Spec it up to Limited Edition Nav and get even more.

VIVARO LIMITED EDITION NAV

SATELLITE NAVIGATION | 17" ALLOY WHEELS
AUTOMATIC LIGHTING | RAIN-SENSITIVE WIPERS
SMARTPHONE DOCKING | VEHICLE GRAPHICS

For more information call 0345 740 0777 or visit
www.vauxhall.co.uk/vans

Official Government Test Environmental Data. Fuel consumption figures mpg (litres/100km) (6.6) - 51.4 (5.5), Combined: 40.9 (6.9) - 47.0 (6.0). CO₂ emissions: 178 - 155g/km.[#]

[#]Fuel consumption information is official government environmental data, tested in accordance with the relevant EU directive. Official EU-regulated test data are provided for comparison



VAUXHALL

and CO₂ emissions (g/km). Vivaro Panel Van range: Urban: 35.3 (8.0) - 40.9 (6.9), Extra-urban: 42.8

purposes and actual performance will depend on driving style, road conditions and other non-technical factors. Correct at time of going to press.

Why wait?

THE AWARD WINNING FORMULA
THAT WORKS!

**PAINT
PANTHER**

**The Award Winning
Paint & Varnish Remover**

Tears through multiple layers of
paint & varnish **incredibly fast!**

REMOVES METALISED PAINT

SUPER FAST ✓

EASY TO APPLY ✓
NON-DRIP GEL FORMULA ✓
REMOVES METALISED PAINTS ✓

AVAILABLE SIZES ✓
4L, 2.5L, 1L, 500ml, 250ml



'The brand you can trust'

Barrettine
TRUSTED BY THE PROFESSIONALS

St. Ivel Way, Warmley, Bristol BS30 8TY.
T. 0117 960 0060 F. 0117 935 2437
E. sales@barrettine.co.uk www.barrettine.co.uk
Gold winner of the DIY Week Decorating Product of the Year 2011.

Brewers *brief*

Take the store with you

We know that to our customers time literally is money and Brewers.co.uk is here to help you source the products you need to get the best results.

As a Brewers Credit Account customer, you can now order online, arrange delivery or collection and manage your account in real time, leaving you more time to spend with your customers.

The online Credit Account facilities mean you're able to check stock at any Brewers store whilst viewing your trade prices at any time of the day. You can keep an eye on your account balance, check over past transactions or print copy invoices and credit notes whenever you need to, all from your account login at brewers.co.uk.

You'll also find some handy tools on the Brewers site to help you select the right product for the job. Our Problem Solver tackles all manner of decorating dilemmas, from treating stains such as graffiti to preparing a metal surface with old bubbled paint. Simply select your tricky substrate or surface defect for guidance.

Customers can also request a site visit or specification for particularly complicated jobs directly from the Brewers site. Simply complete the summary form and we'll get in touch to take the headache out of the planning.

To find out more about any of these online services including opening a Brewers Credit Account, simply visit www.brewers.co.uk today.

Decorating solutions

from Axus Decor

Blue Respirators



Sanding, painting and working with potentially dangerous materials can pose a serious risk to your health. Axus Décor respirators provide the high level of protection required to filter out 99% of airborne particles, functioning at a FFP3 industry standard. FFP3 respirators protect against higher levels of dust, while also effectively blocking solid and liquid aerosols.

Volatile organic compounds (VOCs) include a variety of chemicals, some of which may have short- and long-term adverse health effects. The Axus Décor respirators also includes an Anti-VOC carbon layer, which traps the pollutants in the surface and prevents them from being respired. These respirators are suitable for: painting and varnishing, sanding old paint, plastering, cutting, drilling, grinding, sanding wood, metal, stone, brick, concrete, installation of fibreglass, loft installation, degreasing, aerosol painting and welding. Available in two types: Folded (which is a more economic option) or for better protection choose the shaped respirator.

For stockist information and the latest news, follow on Facebook, tweet @AxusDecor or call 020 8204 1422.

LEWSAN

BUY NOW ONLINE

The solution for stairwell access!

safe, simple & smart
put it in your online cart

STAIRMATE

A unique device enabling the professional decorator to access walls and ceilings above stairs and steps using any conventional ladder.

Tel 01708 473842
www.stairmate.com



The premier trade and employers' association for the painting & decorating industry in the United Kingdom

Join us to get these benefits

Support and Growth

- Legal Support
- Mediation & Arbitration
- Employment
- Tax Support
- Product Information
- Training
- Technical Advice

Market Profile

- Free Profile on Website
- Certification of Quality
- Competitions
- Representation
- A Voice for the Industry

Knowledge and Skills

- Legal Assistance
- Industry Standard Templates
- Insurance
- Tax Advice
- Health & Safety and Risk Assessments
- Employment Support
- Helplines
- Apprentices and Training
- Mediation and Arbitration
- Free Member Magazine

Get in touch

[paintingdecoratingassociation.co.uk](mailto:info@paintingdecoratingassociation.co.uk)

info@paintingdecoratingassociation.co.uk

024 7635 3776



AkzoNobel has opened what it describes as the world's most advanced and sustainable paint factory, in Ashington, North-East England. The Northumberland plant, which cost more than £100m to build, is the largest ever global investment by the decorative paints business and will become the new centre of production for Dulux.

AkzoNobel £100m investment in the North East

AkzoNobel's new factory will be capable of doubling current UK production levels to 200 million litres per year, the equivalent of eighty million 2.5 litre cans of Dulux, in up to 33,000 different colours, approximately enough paint to redecorate every living room, bathroom and kitchen in the UK.

The Ashington plant uses a variety of renewable energy sources, including photovoltaic cells and a biomass boiler, alongside an automated manufacturing process which saves water, waste and energy. AkzoNobel estimates that the

carbon footprint per litre of paint produced at Ashington will be reduced by 50 per cent compared to the facilities it is replacing.

The plant secures 150 skilled jobs in high tech manufacturing for the North East whilst supporting more than 100 additional roles in the local supply chain. Covering an area of 100,000m², the factory has capacity to expand in order to support future growth plans.

All manufacturing technologies within the plant are managed by a single integrated computer system. All key processes, from



BEHIND EVERY GREAT JOB

**ALL NEW SOLVITE
GENERAL PURPOSE
READY MIX**



- LESS TIME TO APPLY
- NO DILUTION REQUIRED FOR DIFFERENT PAPER TYPES
- INSTANT GRAB - NO EDGE CURL
- EASY TO SLIP INTO POSITION
- NO SOAK THROUGH ON HIGHLY ABSORBENT PAPERS

HANGS ALL COMMON PAPER TYPES:-

- ALL LINING PAPER
- LIGHT & HEAVY VINYLs
- WASHABLES
- TEXTURED
- BLOWN VINYLs
- LIGHT & HEAVY EMBOSSED
- EVEN CONTRACT VINYLs

suitable for



paste
the paper

paste
the wall

hangs up to



SAVING YOU TIME AND MONEY

DON'T FORGET

HIGH PERFORMANCE



- REALLY HEAVY WALLCOVERINGS
- FABRIC BACKS
- GLASS FIBRE
- TILE ON A ROLL
- IDEAL IN HUMID BATHROOMS, ON HOT CHIMNEY BREASTS & BEHIND RADIATORS

LIGHT & LUXURY



- PH NEUTRAL FOR DELICATE & HAND PRINTED PAPERS
- NO STAINING OF HIGH-END PAPERS

TO ORDER CALL 01442 278 115 OR EMAIL TELE.SALES@HENKEL.COM

Come and see us on Stand 94 at National Painting & Decorating Show!





the ordering of raw materials to the shipping of finished products, can be initiated without operator intervention. A highly agile production system means the plant is capable of producing paint across the entire AkzoNobel range, which includes Dulux, Dulux Trade, Cuprinol, Polycell, Hammerite and Armstead.

The official launch of Ashington coincided with the announcement of AkzoNobel's 2018 Colour of the Year, a curated colour palette which the company's colour experts and global trend watchers predict will dominate sales in decorative paint markets for the coming year. The 2018 colour will be Heart Wood, a 'grown-up pink' that embodies comfort and ease. Heart Wood blends harmoniously with the materials from which it takes inspiration, giving consumers the freedom to balance softer shades with deeper, bolder tones.

Ruud Joosten, COO of Paints and Coatings at AkzoNobel, added: "Ashington secures AkzoNobel's future as a manufacturer of high tech products, including paints which improve air quality, increase energy efficiency and protect against bacteria. That technical know-how is matched by our expertise in colour, revealed today with the announcement of the AkzoNobel Colour of the Year 2018. Our inspirational

trends and paint produced here in Ashington will together create beautiful, stylish living spaces all over the world."

Matt Pullen, Managing Director UK & Ireland at AkzoNobel, said: "I'm incredibly proud to have attracted this major investment into the UK. Now the UK's number one paint brand can boast the most advanced manufacturing facility anywhere in the world, securing 150 high skilled jobs in the North East."

At the opening, Secretary of State for International Trade Dr Liam Fox said: "The huge investment by AkzoNobel in Ashington has delivered the most advanced paint factory in the world, and an important boost to the local economy. As an international economic department we encouraged AkzoNobel to choose Northumberland because the UK has the right skills base, infrastructure and supply chains to grow their business. Their decision is a vote of confidence in the Northern Powerhouse as a destination for foreign investment, and demonstrates the rock-solid relationship between the Dutch and UK economies."

Ashington will also house the second Dulux Academy, a customized training centre for painters and decorators to provide them with the expertise and

know-how they need for business success. This follows the success of the first £1.4m Academy in Slough which has trained 1,600 people in its first year. AkzoNobel's ambition is to train and upskill 10,000 UK decorators by 2020, in order to play a part in tackling the skills shortage in the construction sector, which risks limiting the UK's house building capacity.

Ashington is AkzoNobel's second major investment in the North East, alongside its Performance Coatings plant at Felling, Gateshead, which employs more than 800 people, out of a total UK workforce of more than 3,500. Earlier this year, AkzoNobel announced an investment of £12.5 million in a technical innovation hub at its Protective Coatings global HQ in Felling in Tyne and Wear. The new state of the art R&D facility will enable more than 100 scientists to develop products in conditions equivalent to the world's most extreme environments.



Start every job with ZipWall®!

***Protect
client property
– and freshly
painted surfaces –
from dust***



Spring-loaded poles up to 6,1 m high

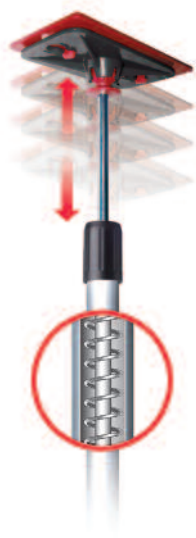

Easy to set up

Save time and money

Improve safety

***See how
it works at
zipwall.co.uk***

***Set up a dust barrier in
minutes!***





www.axusdecor.com



See us at the
**National Painting &
Decorating Show**

28/29 November
at the Ricoh Arena in Coventry

FOLLOW US FOR UPDATES



/axusdecor



@AxusDecor



**Product testing,
competitions, and an
exclusive first look
at some brand new
merchandise!**



STOCKIST INFO:

020 8204 1422





www.olfatools.co.uk



@OLFA_UK



In **1956**, Yoshio Okada, invented the snap-off blade cutter, in Osaka, Japan, and founded OLFA.

For 61 years since, OLFA has had an ongoing investment in advanced manufacturing processes, to ensure that OLFA cutters remain better than any other cutter on the market.



Comfortable, precise, safe and long-lasting products has always been the objective



In **2017**, the OLFA X Design Cutter with **new** Speed Blade is the perfect example of that.

Feel the all-round comfort, the moment you put it in your hand.

Appreciate the fibreglass reinforced body

Glide through tough materials with the fluorine coated, friction-reducing blade

Enjoy operating the fuss-free, jam-free automatic blade lock system

Experience the ultimate in sharpness

Experience the OLFA X Design Cutter at the
2017 National Painting & Decorating Show!

Powering up

Powered access obviously saves time but this must be offset by cost. We look at what Facelift has to offer, together with hire prices.





Dingli AMWP 11.5-8100

This self-propelled boom only weighs 2950kg, gives a working height of 11.2m and also has an outreach of 3m. With advantages such as a light structure, convenient operation, safety, reliability and being battery powered. It has been designed for internal use and is suitable for narrow areas. This machine can be driven from the basket while up in the air.

Hire - £275 + vat for a week's hire

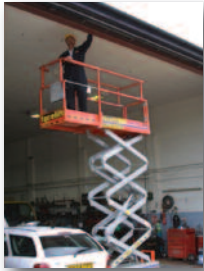

Skyjack 3219

The Sky jack scissor lifts are exceptionally versatile for tight spots where manoeuvrability and agility make all the difference, the Skyjacks are compact and offer great performance in small spaces.

This scissor lift only weighs 1312kg, gives a working height of 7.6m with a safe working load of 227kg (this is the weight you can have in the basket). The platform has an outreach of 0.9m.

This machine is also battery powered and can fit through doorways. You can drive this machine at height so no need to come down and reposition the machine. They also come with non-marking tyres.

Hire - £120 + vat for a week's hire



Skyjack 3226

This scissor lift only weighs 1864kg, gives a working height of 9.7m with a safe working load of 227kg. The platform has an outreach of 0.9m.

This machine is battery powered and can fit through doorways when the cage is collapsed. You can drive this machine at height. They also come with non-marking tyres.

Hire - £160 + vat for a week's hire



Skyjack 4632

This scissor lift only weighs 2300kg, gives a working height of 11.6m with a safe working load of 318kg. The platform has an outreach of 0.9m.

This is the larger of the interior scissor lifts and if you need to have more people and tools in the basket then this would be the best machine due to its larger cage capacity. The machine is battery powered and can fit through double doorways when the cage is collapsed. You can drive this machine at height. They also come with non-marking tyres.

Hire - £170 + vat for a week's hire

If you are looking for some machines with a bit more height...



Niftylift Heightrider 15 Narrow access

Narrow width combined with minimum tail swing and a tight working circle allows the Nifty HR15 pinpoint accuracy when positioning the platform. An on-board diesel engine allows for fast travelling speeds on site and prolonged use in external areas. Reduced working widths makes this machine ideal for use in atriums and warehouses.

This self-propelled boom weighs 6400kg, gives a working height of 15.6m with a safe working load of 225kg. The platform has an outreach of 9.6m.

This machine is bi-energy so can be used with the diesel engine outside or battery powered when used indoors. At 1.5m wide it will need a fairly large entrance to get inside a building. You can drive this machine at height. They can also come with non-marking tyres.

Hire - £350 + vat for a week's hire



Niftylift Heightrider 12

The Nifty HR12 is one of the most versatile machines of its class, designed to give maximum reach and performance from the lightest and most compact base possible. The HR12 operates on both battery and diesel power, enabling it to be used both inside and out.

This self-propelled boom weighs 3060kg, gives a working height of 12m with a safe working load of 200kg. The platform has an outreach of 6.1m.

This machine is bi-energy so can be used with the diesel engine outside or battery powered when used indoors. At 1.5m wide it will need a fairly large entrance to get inside a building. You can drive this machine at height.

Hire - £275 + vat for a week's hire

A moulding for marble

Trompe L'oeil, or trick of the eye, gives depth to a flat surface.
Here's how to achieve one form of it.

By Robert Woodland LCGI, a member of London Association Master Decorators and the
Painting and Decorating Association for over 40 years.

- 1** Prepare a board with a black background in eggshell.
Then glaze the surface with a thin wash of proceed clear
or Polyvine scumble.
- 2** Apply Jenkins green with a rag rolling style to leave
areas open to the black background showing through.
- 3** Add white to the Jenkins green with a touch of raw
sienna on a feather which has been wetted with clear
glaze. Apply to surface making fractures as a matrix
structure keeping the process going but apply lighter colours
as you go. Make the white the last vein fracture colour to the
panel

What you will need:

Pigments: Jenkins Green, Ultra
Marine Blue, Zinc White, Raw
Sienna, Black these can be
golden pigments or Daily Rowley.
Goose / Swan feather,
Water based medium glaze
such as Proceed / Polyvine.
Lint free cotton rag.
Background board. Black
eggshell board Acrylic or oil.
600x 400mm.

Mouldings

- 1** Set out profile (see pic 1) according to design chosen for the moulding. Here I have chosen a
picture frame style with white wax crayon. Pic 2 has different widths which I made as a template
on paper.

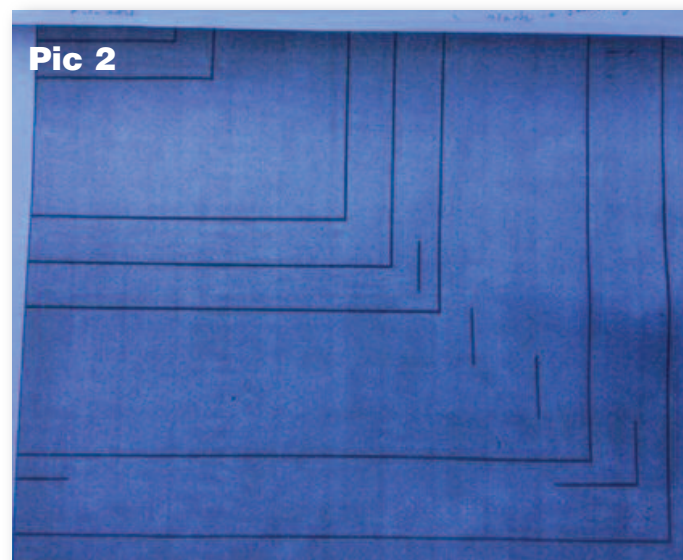

When setting out the moulding, try to imagine a light source shining from one angle. I have used
top and right side light / white. Bottom and left side dark shading under the wax lines

To do this shading I have used Jenkins Green and a little black. I have applied it over a re-glazed
wet marked out areas along the lines to give a painted shadow. Stipple the edges to soften away
from the sharper line.

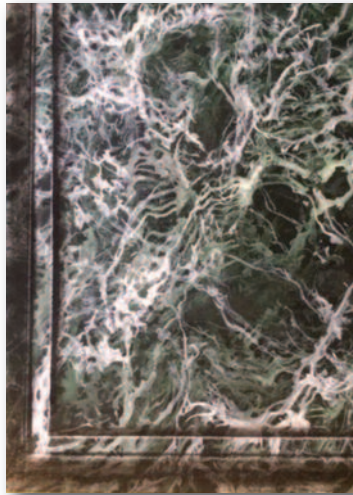
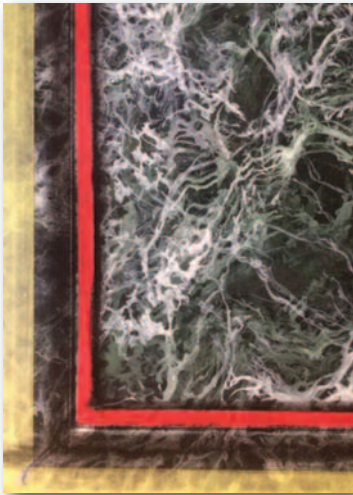

2 Use a mitred corner to produce the effect of a shaped moulding. I used the "S" shape and reverse it for the other side.

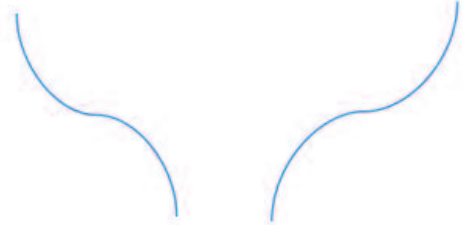

3 For flat corners without shape, use a 45% angle. Use tape to form the thickness of the shadows (as in photos) this helps gauge the thickness of the lines.

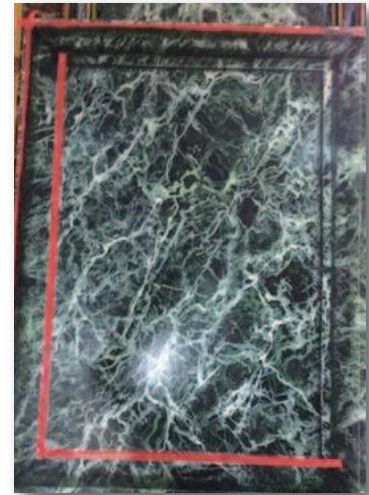

4 Apply tape around edges on the opposite side of the line to produce the thickness of the shading. Apply shading working away from the tape line to a stippled edge.

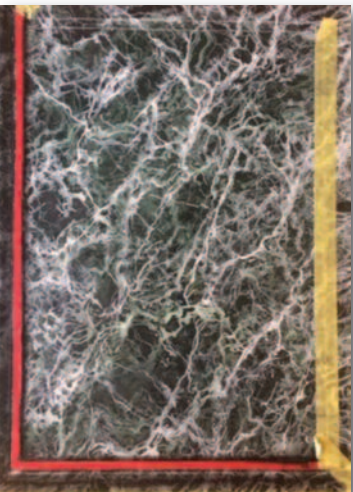

5 To finish, use a water based satin varnish and apply several coats to the desired quality. Here I have gone for a commercial finish of Marble Painting.

Last stage, go and make yourself a cuppa, return and smile.



On test: Sheet Sanders

We all know that the secret of a good finish is preparation, a smooth surface will give a smooth finish and to that end we asked some of the suppliers to send along their wares to look. To keep a good focus we looked at just 1/4, 1/2 and 1/3 sheet sanders and just to spice it up a detail sander, we'll do a survey of those next time.

Draper 86342 Stormforce

Guide Price	£ 27.66
From Screwfix (Free UK delivery)	
1/2 sheet or 1/3	1/3
Wattage	135
No Load OPM	12,000
Weight	1.5kgs
Contact	02380 494333



Low cost 1/3 sheet orbital sander with rubberised front and rear handles. Easy to attach sanding sheets with a clamp at each end of the base. Supplied with a nozzle for connecting to an extractor system but no dust bag supplied. Light and easy to use. You find in the box two sheets of P80 grit sanding sheets.

Clarke CON300

Guide Price	£41.99
From Machine Mart	
1/2 sheet or 1/3	1/2
Wattage	330
No Load OPM	6,000 – 11,000
Weight	2.62 Kgs
Contact	01992 565300



A big orbital sander with a solid feel, rubberised top and rear handles good positive grip. Sanding sheet held by strong clamps opened by plastic levers in the body of the sander. You find in the cardboard box in which it comes a dust bag and 9 sanding sheets, 3 of P60, 3 of P120 and 3 of P240 grit. Adjustment of the speed of the oscillations is by a thumb wheel on the top of the handle.

Draper PT220SF

Guide Price	£ 39.59	From Machinemart
1/2 sheet, 1/4 or 1/3	1/4	
Wattage	220	
No Load OPM	13,000	
Weight	1.4kgs	
Contact	02380 494333	



Handy palm sander with a 1/4 sheet, comes with a dust box instead of a dust bag and an extension piece for connecting to a central dust extractor. There's rather a fiddly on off switch at the front of the handle. The top of the motor case is covered in a rubberised material for good grip. Sheet retention is by sprung clamp. Handy tool.



*Woodcare
Experts Since*
1912

Liberon have been providing the highest quality and innovative woodcare products since 1912.

We have the right products for you to keep your precious woodwork and timber furniture looking its very best. We have an extensive range of Oils, Waxes, Varnishes and Stains in traditional and contemporary colour finishes.



*We have all the woodcare
solutions you need.*

For more information on our products and our stockists
please get in touch: www.liberon.co.uk | 01797 367555



Clarke PS105 Detail Sander

Guide Price	£23.98 From Machine Mart
Pad Size	140 X 99mm
Wattage	105
No Load OPM	12,000
Weight	0.95kgs
Contact	01992 565300

This sander will get into places where ordinary sanders will not. The pad is shaped like a smoothing iron so there is a point where you can sand right into corners. No dust bag but you do find in the blown plastic case a very comprehensive set of sanding and scouring pads. There are 5 off of P60, 5 off of P80 and 5 off of 120 grit, a foam pad, wire wool pad and a scrubbing pad.



Screwfix Titan TTB288SDR

Guide Price	£22.99 Screwfix
½ sheet or 1/3	1/3
Wattage	220
No Load OPM	11,000
Weight	2.0kgs
Contact	Your local Screwfix Store

Low cost high value 1/3 sheet orbital sander complete with a dust box and is presented in a blown plastic case and you will find three sanding sheets of 1 X P60, 1X p120 and a sheet of P240. In the case you'll also find a hole punch in case you have bought sheets without holes that allow the passage of dust to the dust box.



Makita BO4900

Guide Price	£164.88 Powertools 4U
½ sheet or 1/3	½
Wattage	330
No Load OPM	10,000
Weight	2.7kgs
Contact	01908 211678

Another big and chunky ½ sheet orbital sander, normal high end quality one expects from Makita. Positive front ball type front handle but alas no rubber coating to the handles. Makita put just the one sanding sheet into the cardboard box with the dust bag. If you want speed control you'll have to fork out a bit extra for the BO9400V.

Makita BO4555

Guide Price	£64.99 Screwfix
½ sheet ¼ or 1/3	¼
Wattage	600
No Load OPM	14,000
Weight	1.1kgs
Contact	01908 211678



A neat little ¼ sheet palm sander with a somewhat fiddly on/off switch if wearing gloves in the front of where the operator would put their palm. The top of the sander is coated in a rubber material. Attaching the sanding sheet is a simple and easy operation with a lever operated clamp fore and aft of the pad. Along with a dust bag there is an unusual sandpaper punch to place holes in the sheet to facilitate free flow of air for the dust extraction to the little bag. Very well made tool.

Screwfix 9013G Erbauer ERB617SDR

Guide Price	£44.99
½ sheet or 1/3	1/3
Wattage	240
No Load OPM	6,000 – 11,000
Weight	1.6Kg
Contact	Your local Screwfix Store



Excellent value third sheet orbital sander with adjustable speed, comes in a fabric valise with a dust box and connector for a dust extraction system. Screwfix throw in 6 sanding sheets, 2 X P80, 2 X P100 and 2 X P120. Rubberised top handle and front palm boss plus easy to attach sanding sheets with clamps on the base plate.

Quality...



Meet us on
Stand 33
28-29 November
RICOH Arena,
Coventry



Uncompromised

CORONA®

web. www.coronabrushes.co.uk
tel. 0333 20 21 031
email. sales@coronabrushes.co.uk

On test:

Renault Master LM35 ENERGY dCi 145 Business

by David Stokes

As is the fashion nowadays the Renault Master arrived looking very imposing, indeed with its massive slanting headlights and almost smiling face and the Renault icon big and proud in the middle of the grill. With five power settings the 2.2 litre diesel is found in all of the versions whether they're front or rear wheel drive or even 4X4. There are pickups, panel vans, crew vans and can also be supplied in chassis cab form. The choice of power settings start at 110hp, 130hp, fitted with a single turbo and the 145hp, 165hp and 170hp, being in twin turbo form.

The version of Master supplied to me was the LM35 having a 145bhp 2.2 diesel which is halfway up the Master food chain. I found it a delight to drive and like most vans in these enlightened times, at least for van drivers, was almost car like to drive. The twin turbos certainly make the van lift its skirts and one can find oneself the wrong side of 70mph before it is realised.

Out on the road you find the steering is a

trifle on the light side so no massive biceps needed but some might find it a little on the vague side. Changing to any of the six speeds is by the dash mounted stick found on most vans nowadays which allows the driver easy access to the other side of the cab if its necessary to park hard up against a wall on the driver's side. There are six speeds in the gearbox and only the 170hp version has the Quickshift6 automated transmission and only with front wheel drive. The handbrake found between the seats is the normal press button type.

The cab is very well designed and a lot of thought has obviously gone into it. There is a host of cubbyholes in the doors and the dash and the cab storage space combined is 150 litres. In each of the doors is a slot for a 2 litre bottle to ward off dehydration. On the top of the dash is a slide down clipboard for those important delivery forms and places to see the address where you need to go.

If driven with an eye on the cost of diesel the LM35 version should with the 145hp



engine return around 40mpg and the 145hp engine is the best in the whole range in terms of economy in front wheel drive setup and is also the best for the lowest emissions at 183g/km. Service intervals are set at 25000 or 24 months.

All the Master panel vans are fitted with a full height bulkhead keeping the front seat occupants safe from flying objects in times of hard braking. There are many lashing points on the floor of the cargo area. A loading pack costing an extra £800 consists of a resin coated plywood covering, a right side sliding door, 270 degree opening rear doors and floor a three button key fob. And a further £500 will see you get 16inch alloys and front fog lights.

There were many extras on the test van which I could see many employers not buying except for the sat nav as that does



NEW

**Masq range launching
on Stand 95 at
this year's show.**

Don't miss out!



**Your TRUSTED EXPERT for
Painting Tool Solutions**
**Ciret - Providing quality,
service and
innovation to the painting and
decorating industry!**

ROTA!

kana

masq

prep

www.ciret.co.uk or call us on (+44) 02392 457450



save so much time and wasted miles. However the R-Link Evolution multimedia system giving you an MP3, CD player and Dab radio plus Bluetooth at a not insignificant £675, along with the metallic paint, £450, rear step, £350, additional anchorage points, £75, 105 litres fuel tank, £100, cornering lights, £130, Cruise control and speed limiter, £250, rear parking camera, £350. He would have to be a very kindly and generous boss to afford his staff that level of luxury.

All in all though, an excellent van, great to drive, and has a high build quality.

Basic 'On the Road' Price £38,551 as tested £42,231

Specification:

Engine Type	4 In Line Diesel
Capacity	2.298cc
BHP	145 @ 3,500rpm
Torque	340 @ 1,500rpm
Gearbox Transmission	6 Speed Manual

Brakes	Ventilated Discs Front
Disks Rear	+ ABS, EBD, EBA
Steering	Power Assisted

Fuel Economy

Combined	39.2mpg (Approx)
----------	------------------

Dimensions:

Overall Length	5048mm
Overall Width	2470mm with door mirrors
Height	2303mm

Wheelbase	3182mm
Internal Width between wheel arches	1380mm
Gross Vehicle Weight	3,500Kgs
Payload	1602Kgs
Max Trailer Weight Unbraked	750Kgs
Max Trailer Weight Braked	2,500Kgs
Kerb Weight	1898Kg



same
great
products



new
look
pack

find us in store or
online at
www.polyvine.com



GO! Paint

Roll and Go XL

The heavy duty paint scuttle



Original painting by Dutch master Willem van de velde II, painted for the British Royal Family, circa 1860, Property of Rijksmuseum, Amsterdam, the Netherlands.



Visit us on stand 4 at the P&D show
for exclusive promotions and demos.

GO! Paint
WWW.GO-PAINT.COM

Liberon's exterior furniture cream

Liberon has launched an Exterior Furniture Cream which can be applied quickly and easily by hand, with a cloth.

Ideal for all types of exterior woods, the formula protects and preserves exterior timber, maintaining its natural appearance.

Quick and easy to apply with a cloth, with no need for a brush and no need for surface preparation, the cream penetrates deep into the wood to offer a superior level of protection against water, stains and UV damage. The cream can be used on top of oils and varnishes for a natural finish and is available in clear or teak.



Tile with time on your side

We all know that certain tiling jobs call for more fixing time. That's why Dunlop's Flexible Slowset Floor & Wall Tile Adhesives sets nice and slow, giving you up to 20 minutes to fix and adjust your tiles.

Water and frost resistant, Dunlop Flexible Slowset can be used internally and externally and is suitable for use with floor and walls tiles including porcelain, ceramic, mosaics, quarry tiles and brick slips.

A flexible C2TE adhesive, Dunlop Flexible Slowset is perfect for underfloor heating or swimming pools, and because of its slow-setting formulation it has a pot life of 4-5 hours after mixing – meaning less mixes for larger jobs.



DEFENDERS OF DECORATORS PROTECTORS OF PROFESSIONALS

THIS. IS. DUNLOP PRO DÉCOR.

**ACHIEVE A PERFECT FINISH EVERY TIME, IN RECORD TIME.
A RANGE OF FILLERS AND SMOOTHERS DESIGNED TO SAVE THE DAY.**



Find your friendly
neighbourhood stockist at
www.dunloptrade.com

✉ info@building-adhesives.com
📱 @DunlopProDecor
📍 Dunlop Adhesives UK

coo-var®

PAINTS, PRIMERS AND SPECIALISED COATINGS

Anti-Condensation Paint

Our textured paint is designed to prevent the formation of condensation

FAST DRYING ✓

WATER BASED ✓

SUITABLE FOR WOOD, PLASTER, BRICK & METAL ✓

LIGHTLY TEXTURED MATT FINISH ✓

RESISTS DECOLOURING ✓

500ML 1L & 2.5L AVAILABLE ✓

Anti-Damp Paint

Combines with moisture to preserve and protect layer

FOR INTERIORS & EXTERIORS USE ✓

WATER BASED ✓

FAST DRYING ✓

PROVIDES EXCELLENT ADHESION ✓

SUITABLE FOR DAMP SURFACES ✓

PLASTER, BRICK & BLOCK ✓

500ML 1L & 2.5L AVAILABLE ✓



It's not just about the paint!

Cleaning,
preparation
and Repair

Floor, Skirting
and
Line Marking

Safety
and Security

Hammercote
and Products
for Metal

Specialist
Paints

Varnishes
and Oils

Specialist
Primers



01482 328053

www.coo-var.co.uk



Clean up with Crown Trade Clean Extreme



The power of Crown Trade Clean Extreme has seen the product gain a new style billing, focused on its stain removing powers.

Crown Paints has repackaged its polished performer – one of the most popular products in the Crown Trade range among decorators – to highlight its class-leading capabilities.

New packaging designs for the Crown Trade Clean Extreme range of products highlight that the product is 100 per cent more stain resistant than standard matt vinyl emulsion paint - and can be scrubbed up to 10,000 times.

Available in Scrubbable Matt and Durable Acrylic Eggshell, Crown Trade Clean Extreme comes with an ISO 11998 Class 1 scrub rating and is geared up to cope with stringent cleaning regimes, ultimately reducing the need for costly redecoration by minimising wear and tear.

This ensures the product retains its 'as good as new' finish for the long-term, extending maintenance cycles in heavy traffic areas.

FEIN deals



FEIN is now offering special editions of its current oscillating machines. Both the new versions of the corded and cordless Multi-Master and SuperCut will be supplied in a double Systainer, the end user benefitting from an average saving of £200 compared to buying each item individually.

The double Systainer helps tradesmen to neatly store and transport both tools and accessories – saving the need for additional trips. The upper Systainer contains FEIN E-Cut saw blades, other oscillating multi-tool accessories and more. The tool itself is safely stowed in the lower compartment. Both tool cases are connected together using a click connector and they can also be linked to premium class FEIN Dustex extractors, as well as all extractors with Systainer fittings.



BEDEC
THE PAINT COMPANY



WATER BASED METAL PRIMER FOR ALL METALS



All metals, water-based rust inhibiting primer.
After extensive testing, a metal primer
for ALL ferrous and non-ferrous metals,
prior to painting with water or oil-based paints.

Innovators in Water-based Technology

Tel: +44 (0) 1279 876 657

Email: info@bedec.co.uk

www.bedec.co.uk

MIRKA



Gets you closer. For perfection.

Imagine the perfect surface. Thanks to the new Mirka® DEOS electric sander, you can obtain that flawless end result easier and quicker than ever before. By getting you closer to the surface, we bring your sanding experience to a completely new level — you will never go back to hand sanding again.

Mirka® DEOS boasts an extremely powerful brushless motor, so we are able to shave off weight, size and height. Add smart Bluetooth connectivity and an integrated vibration sensor and you can monitor vibration levels while sanding.



w: mirka.co.uk
t: 01908 866100

Quality from start to finish

Furniture wax



A rich, dark brown colour with butter-like texture that is virtually odourless, Frenchic's new Browning Wax will seal your painted furniture, and give it a depth of age and richness. Simply apply using Frenchic's signature waxing brushes, wipe off any excess and leave for 45 minutes until buffing.

The Frenchic range now includes 30 colours in their Original Range, 15 colours in their Lazy Range and 6 in their Al Fresco Range, alongside their Easy Crackle, Finishing Coat, waxes, stencils and accessories. All are EN:71-3 certified meaning they are safe to use on children's toys, and are virtually odour free with no VOCs.

Self undercoating Albany

Albany Super Gloss and Super Satin are water based products which can be used on interior and exterior surfaces. Created using modern formulations, these new products are self undercoating, offer excellent opacity and dry quickly with little odour.

Albany Super Gloss and Super Satin will provide a longer lasting whiteness when compared to traditional oil based products. One litre of these new products will cover up to 15 sq metres, be touch dry within 2 hours and are recoatable after 4-6 hours. Super Gloss is available in 1lt White and Black and 2.5lt White. Super Satin is available in 1lt White and 2.5lt White.

We apologise for using the incorrect image to accompany Albany's oil based satin product story in the last issue and indeed the missing hyphen. Drying time is 4-6 hours and not 46 hours.



Save time with the NEW premixlight

- Convenient, ready mixed
- Workable for easy application
- Smooth texture for effortless sanding
- Multi-purpose for hand or machine application
- Minimal shrinkage
- White in colour, easily paintable

Please contact Wondertex:
01827 254402



wondertex.co.uk

CROWN DECORATING CENTRES

CHAMPIONS^{10%}

Rewards



IT'S SIMPLE

1

**SPEND
MORE THAN
LAST YEAR**



2

**WE'LL WORK
OUT THE
DIFFERENCE**



3

**GET 10% OF
THE DIFFERENCE
BACK!**



**WE'LL REWARD YOUR LOYALTY WHEN
YOU ACHIEVE YOUR PERSONAL BEST!**

Grow your account with us between 5th June and 30th November 2017 and be rewarded with 10% back in your choice of a One4all Gift Card or credit on your account.



It's easy to find your local store.

We've got over 130 to choose from!

Simply text CROWN to 83332 and we'll message you with details of your nearest store, or visit www.crowndecoratingcentres.co.uk and go to our store locator page.

**SIGN UP IN-STORE BEFORE
30TH NOVEMBER**

"That's why I rely on Crown"

CROWN DECORATING CENTRES PROUD SPONSORS OF



It's not just paint.
It's personal.®

*T&C's apply. Ask in-store for details. Offer valid from 05/06/17 - 30/11/17 inclusive.

Graco ups productivity

The new HVLP TurboForce™ II from Graco is designed with simple, easy-to-use controls that increase productivity and extend the life of sprayer components. It gets the job done in 25% of the time: the new exclusive air cap design increases the fluid flow in every needle by four times.

The unique FlexLiner™ Bag System allows you to spray at any angle, even up-side down. It delivers superior fine finish results, while reducing clean up time.



Washability and abrasion resistance



Designed for dry and humid spaces where good washability and abrasion resistance is required, Timantti 20 is a semi-matt special acrylate waterborne paint from TeknosPro. It is especially suited to the interior walls and ceilings of kitchens, bathrooms, halls and staircases in schools, hospitals, food processing premises and other similar facilities.

The Timantti product family comprises a series of professional grade products designed to endure, protect and isolate. Timantti 20 is mildew resistant and the painted surface can be washed repeatedly. Together with Timantti W moisture sealer, the paint is included in a coating system for wet rooms, approved by the Swedish Måleribranschens Våtrumskontroll (MVK).

Environmentally friendly, TeknosPro coatings comply fully with European VOC emission standards and REACH regulations. Timantti 20 has low VOC levels and no odour and is classified to Group M1 of the emission classification of building materials - the best classification and standard for low-emission.

bromboroughpaints

Wallcovering & Paint Specialists. Est. 1948

Supplying the trade since 1948

- All major brands available
- Colour mixing service
- Extensive selection of wallcoverings
- Wide range of decorating tools & materials
- Competitive prices
- Friendly, expert advice

For more information call: 0151 334 1237
or visit www.bromboroughpaints.co.uk



...we've got the North West covered!

MUR EX[®]

ALL SUBSTRATES REPAIR FILLER

[FILL AND
REPAIR]



- **ROCK HARD**
- **EXCEPTIONAL ADHERENCE TO ALL SUBSTRATES**
- **WILL NOT FLASH OR GRIN**
- **WHITE IN COLOUR**
- **PAINT IN 24 H**
- **NO STABILISING SOLUTION OR PVA REQUIRED***

* On hard, cohesive, clean, sound and dry substrates

TOUPRET UK
25 North Row - London W1K 6DJ
Phone: +44 (0)203 691 6747
Fax: +44 (0)20 3691 6751
Email: toupretuk@toupret.com
www.toupret.co.uk

TOUPRET[®]
FILLERS FOR THE TRADE

Bosch 18 V cordless tool range expands



Bosch has added six new products in the growing 18 Volt cordless power tool market. Adding extra options in terms of hammer drilling, angle grinding, shearing, nibbling and dust extraction, they expand the Bosch Professional 18 V Li-Ion range to more than 40 tools.

The collection includes a wide variety of drills, drivers and hammers for different applications. There are other tools for sawing, cutting, grinding, planing and sanding, along with dust extractors, lights and even an onsite radio.

Drywall taping

The National Abrasives MudGun drywall finishing system is designed to help both professionals and inexperienced users tape drywall faster with much less mess using a preloaded, adjustable applicator. The MudGun contains everything required, says the company, for embedding tape and finishing the surface. It's available in two versions; one that uploads joint compound/mud directly from a 17-20 litre bucket; and a second that uses pre-packaged MudPaks (premixed joint compound) for quick and easy to National Abrasives taping. A conversion kit is also available to turn the MudGun Easy Load into a bucket-loading system.



"UNMISSABLE!"



"THIS YEAR'S HOT TICKET"



"BRILLIANT CAST!"



FREE TICKETS:
paintshow.co.uk

MORE INFORMATION:
paintshow.co.uk

THE NATIONAL
**PAINTING AND
DECORATING
SHOW**



SHOWING 28/29 November 2017 RICOH ARENA, COVENTRY

New Durable Acrylic Matt

Macpherson Trade Paints has developed a new Durable Acrylic Matt, featuring a water-based formulation that is both stain and moisture resistant. The hardwearing, value-for-money product offers a great finish for interior walls and ceilings, with Macpherson Trade Paints' recognised hallmarks of quality and reliability.



Available in Brilliant White, Magnolia and over 7,000 tint shades, Macpherson Trade Paints' Durable Acrylic Matt can be applied by roller, brush or spray.

It is touch dry in two hours and ready for recoating after four hours.

The clear advantages of Osmo

Osmo UK, has developed a quality finish to protect, maintain and restore exterior wood. Osmo UV-Protection-Oil has been specially designed to preserve the natural colour of the wood.

Osmo UV-Protection-Oil is a clear, satin finish for exterior application onto vertical wooden structures only such as doors, cladding, fencing etc. Based on natural oil, it does not crack, flake, peel or blister. This natural protective finish has been produced to resist the greying effect on exterior wood due to exposure to the sun, maintaining the wood's natural aesthetics. The UV-Protection-Oil 410 consists of natural ingredients and is safe for use on children's play equipment, flower boxes as well as animal housing, whilst UV-Protection Oil Extra 420 contains additional active-ingredients perfectly blended in order to reduce algae and fungal decay and provide optimal protection during winter periods.

Snickers climate control workwear

A change of season means a change of focus on what you wear on site, so Snickers FLEXIWork, RUFFWork, LITEWork and ALLROUND Workwear ensures you keep your cool when the heat is on or warm and comfortable when the temperature drops.

Interweaving 37.5® Technology fabric into Snickers' working clothes means that you've got a wide choice of waterproof and windproof Jackets, mid-layer Fleeeces and Stretch Hoodies.

Plus base-layer undergarments, gloves and headgear that ventilate and moisture transportation to keep you working comfortably wherever you are on site.

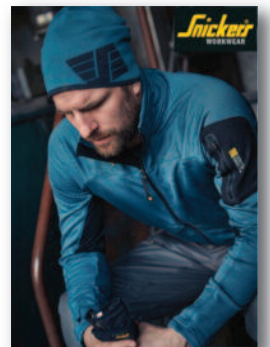

Sandtex®

The No.1 exterior solution **TRADE**



Whatever the weather...



Can be applied in temperatures as low as -10°C

- Formulated with Pliolite resins
- Rain resistant in 20 minutes
- Excellent opacity
- BBA approved 15 years durability

Sandtex®, Proud Sponsors of



www.sandtextrade.co.uk

Wagner's

new Control Pro

The new Airless paint sprayers from Wagner feature reduced pressure, minimised overspray and maximised control. That means fast, efficient paint application



WAGNER Control Pro Anwendung Lasur

Wagner's Control Pro systems work with low pressure, delivering a very fine spray jet thanks to pioneering pump technology and the new WAGNER HEA nozzle.

The reduced pressure and innovative nozzle make these machines easy for anyone to use. Paint is applied in a gentle spray that provides greater control, thereby reducing errors and eliminating the need to cut in corners and edges. With up to 55 percent less overspray, the need for masking is reduced.

Using different nozzles, Control Pro can handle a wide range of paints including water- or solvent-based emulsion, vinyl, matt, silk, gloss, smooth masonry, primer, enamel, satin, lacquer, undercoat, stain and varnish. A direct intake function draws paint directly from the original container. So even large-scale projects can be carried out quickly and conveniently, without constant refilling.

Depending on the model, Control Pro sprayers come with either a carry handle or wheels. There's even an integrated storage box for tools and accessories.

Included as standard with all Control Pro systems is a high-quality Airless gun. This lightweight, ergonomic gun can be used for extended periods without getting tired. A one-finger lock also allows users to unlock the gun and spray using just one hand. Also included is a nozzle for wall and ceiling paints and another for wood and metal paints. Further HEA nozzles are available as accessories, and so is a nozzle extension that increases the reach – for spraying ceilings without a ladder, for example.



WAGNER Control Pro 250 M



WAGNER Control Pro



WAGNER Control Pro 250 M

COMING
SOON from **ProDec**



PERFORMANCE
GUARANTEED

OR YOUR MONEY BACK



See it first on
Stand 79



HEAVY DUTY HARD SURFACE PROTECTION

FloorShell™ - heavy duty construction board with liquid resistant, breathable protection to allow new surfaces to continue curing. Plus, the scored edge makes it simple to protect skirting boards and walls. Strong enough for forklifts!

Aqua Shield™ - Fire retardant and dust free protection available in three thicknesses - 254 microns, 635 microns and 1016 microns.

X•Board - With the same liquid resistant and breathable qualities as FloorShell, X•Board offers a lighter weight alternative for hard surface protection. Quick and easy to lay down and will last for the duration of the job.

AVAILABLE FROM BREWERS DECORATOR CENTRES AND LOCAL DECORATORS MERCHANTS



Manufacturers of KleenEdge Low Tack Painting Tape
01746 218091 | www.trimaco.com

Ciret Ltd

The UK distributor for Trimaco products
02392 457450 | www.ciret.co.uk